

Factory is Specialized in producing high quality functional tube equipment ,hard stitching power training items, Weightlifting products and so on over 18 years' experience .

We have 30 experienced employees to engaging business who can supply you professional service. Tube equipment factory covers 4000 square meters and has various workshops such as tube cutting, machine workshop , welding workshop and assembly workshop . In addition , hard stitching factory covers 4000 square meters and has cutting line , printing line , stitching line , filling line and assembly lines .

We take great pride in our ability to provide a comprehensive , end to end solution for your requirements. Whether you are looking for home use items or gym club studio equipment. Our team of skilled professionals works diligently to create innovative designs that cater to the evolving needs of fitness enthusiasts.

Main Products: Fitness equipment , Functional training equipment, weight lifting items, and stitching lines.

Design Team: 1/ To provide customers prospectus how to set up a new gym club or studio ; 2/ Provide products design, package design for importers.

QC Team: All items are with the customer own SOP as a license.All shipments are with inspection report and pictures fo each item . Can upload for customer checking if required.

Service: Feedback within 24 hours; sample cost will all payback after order; package design for free after order ; additional service for customer to inspect other factories with report.

One-stop service

Located in famous Industrial Belt for sporting goods and fitness - Nantong City.

ABOUT US

INTRODUCTION

COMPANY

FREE LIKE SUNSHINE

VIGFIT

01 Multi-functional training equipment

02 Power Rack

03 Smith Strength Machine

04 Power Bench

05 Hip thrust & GHD machine

06 SLEDS

07 Cardio Equipment

08 Flooring Mat

09 Dumbbell

10 Weights

11 Barbell

12 Storage Rack and Squat & Chin up

13 Platform

14 Accessories

15 Medicine Ball

16 Power Bag

17 Weight Vest

18 Attachment

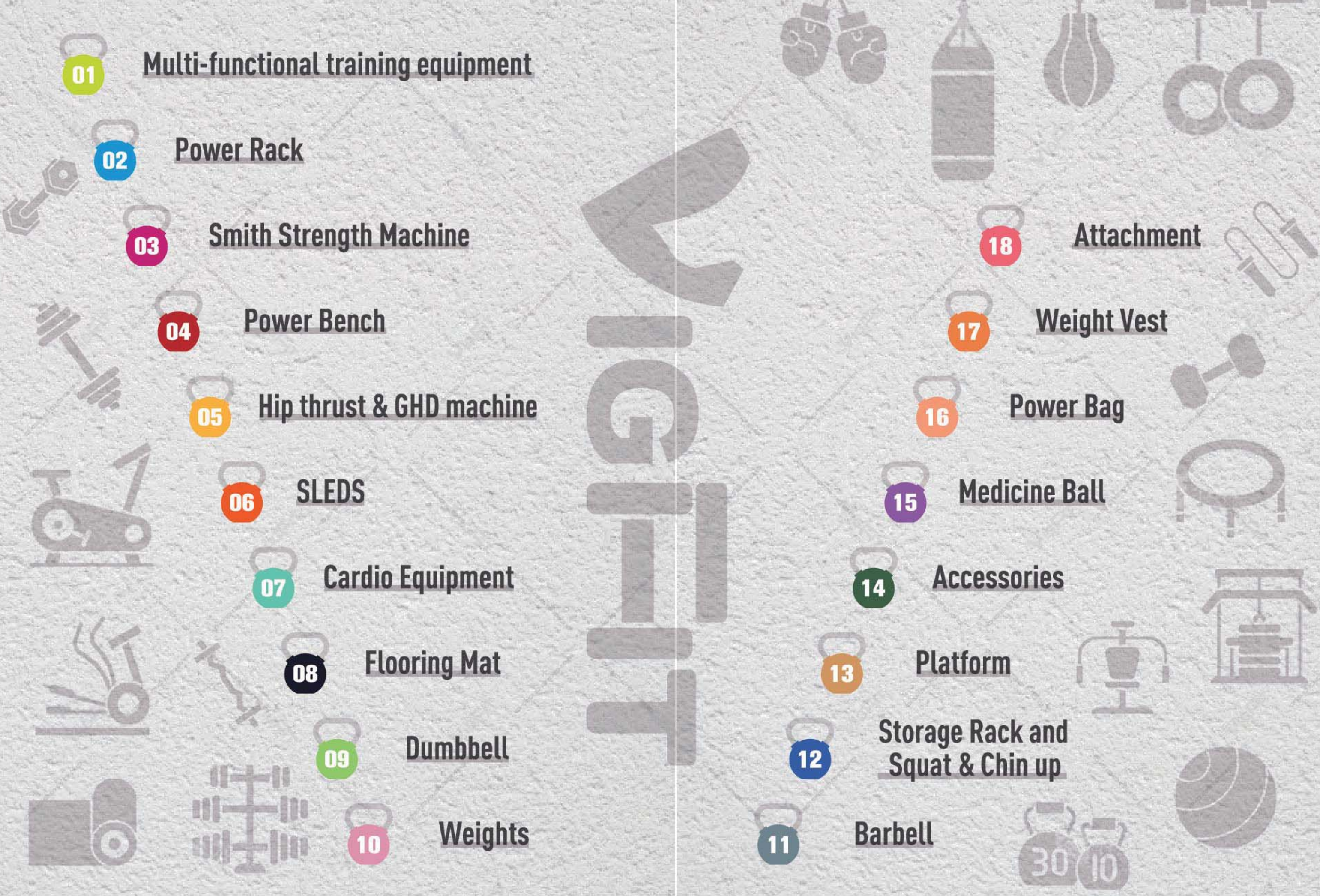

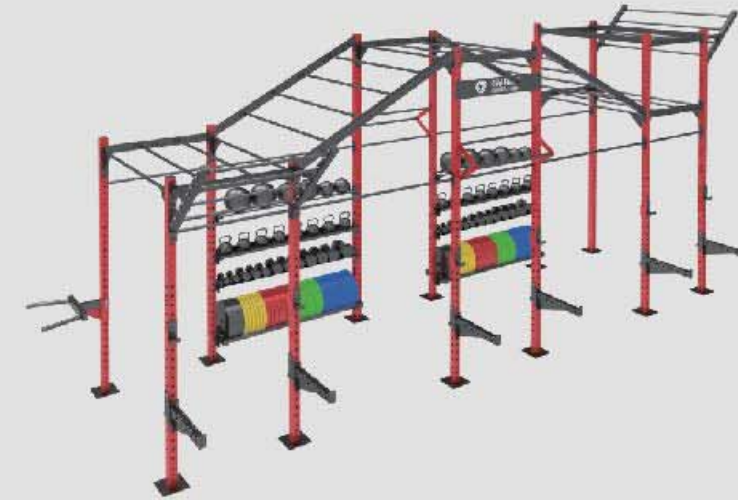

**CFR1702-12
MULTI-FUNCTIONAL
RACKS**

Capacity 10 trainers workout at same time
Main tube: 75 x 75 x 3mm, Ø32 x 5mm
Assembly Size: 7500 x 3100 x 3750mm



Laser Mark



Laser Cut Mark

MULTI-FUNCTIONAL RACKS CFR1701-08

Capacity 8 trainers workout at same time
Basic accessories
Main tube: 75 x 75 x 3mm, Ø32 x 5mm
Assembly Size: 4300 x 2100 x 3200mm

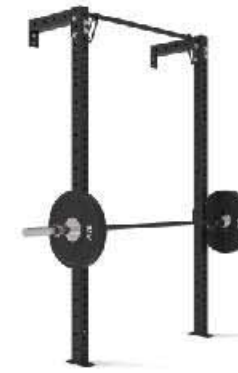

HALF POWER RACK FPK005F-2

Main tube: 75 x 75 x 3mm
Upright tube height choose: 1.8 / 2.5 / 2.7 / 3.7M
Monkey bar: 32 x 3 mm x 1080 mm / 32 x 5 mm x 1800mm
Wall mount distance: 450mm ; 750mm for choose



WALL MOUNTED RIGS FPK005F-3

Main tube: 75 x 75 x 3mm
Upright tube height choose: 1.8 / 2.5 / 2.7 / 3.7M
Monkey bar: 32 x 3mm x 1080 mm / 32 x 5mm x 1800mm
Wall mount distance: 450mm ; 750mm for choose
Depend on your space



MULTI-FUNCTIONAL RACKS CFR2022-16

Capacity 14 trainers workout at same time
Main tube :
75 x 75 x 3mm; Ø 32 x 5mm
Assembly size:
L 690 x W 690 x H 315cm

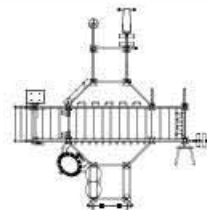

WALL MOUNTED RIGS FPK005F-5

Main tube: 75 x 75 x 3mm
Upright tube height choose: 1.8 / 2.5 / 2.7 / 3.7M
Monkey bar: 32 x 3mm x 1080mm / 32 x 5mm x 1800mm
Depend on your space



MONSTER LITE RIGS FPK005F-S

Main tube: 75 x 75 x 3mm
Upright tube height choose: 1.8 / 2.5 / 2.7 / 3.7M
Monkey bar: 32 x 3mm x 1080mm / 32 x 5mm x 1800mm
Depend on your space

HOW TO SET UP TRAINING STUDIO STEP BY STEP



HALF POWER RACK FPK020-2W

Main Tube: 75 x 75 x 3mm;
Upright tube height choose :
1758/2158/2558mm
Width: 1230mm



HALF POWER RACK FPK020-HR

Main Tube: 75 X 75 X 3mm
Assembly Size: 223 X 124.5 X 228cm
Carton 1: 225 X 22.5 X 18cm, 53/56kg
Carton 2: 116 X 31 X 19cm, 38/40kg
Carton 3: 92.5 X 40 X 18.5cm, 25/27.5kg



POWER CAGE FPK020-4

Main Tube: 75 x 75 x 3mm;
Upright tube height choose :
1758/2158/2558mm
Base feet length choose:
1200/1550/1850mm
Width: 1230mm



LAT TOWER FPK020B

Simple and convenient operation
Weight ratio 1: 1
Highly flexible, expansion steel rope with black plastic coating
Weight: 75kg



POWER CAGE FPK020-6

Main tube: 75 x 75 x 3mm;
Upright tube height choose :
1758/2158/2558mm
Base feet length choose:
1200/1550/1850mm
Width: 1230mm



**FPK020A
LAT TOWER WITH WEIGHT**

Double bearing rope pulleys and extra wide with special shaping of the cable guide suitable for obliquely directed pull exercises up to 40°
Weight: 200kg (lat pull stack weight 115/125kg; 255/275 LB; Steel weights 5kg or 10 LB)

Both LB/KG
Label Sticker

COMBINATION



POWER RACK FPK020A

Double bearing rope pulleys and extra wide with special shaping of the cable guide suitable for obliquely directed pull exercises up to 40°
Weight: 200kg (lat pull plug weights 125 kg steel weights, 5kg each)



POWER RACK FPK020B

Simple and convenient operation
weight ratio 1:1
Highly flexible, expansion steel rope with black plastic coating
Weight: 75kg



POWER RACK FPK020CA / CB

Middle parts can be plywood, rubber mat or top quality bamboo.
Platform two side can add bumper plate holder and so on.
Weight platform:
Size: 2.5 x 3.4m (middle part width: 1.1m)

MULTI PURPOSE

All the attachment you can choose and add as you want, set up the tower as your purpose. Building your own gym station



A + B + storage

**FPK014A+FPK014B+RIG
MULTI POWER RACK**

Assembly size: 4260 x 1500 x 2300 mm



**FPK014A
POWER SQUAT RACK**

Main tube: 75 x 75 x 3mm
Assembly size: 1300 x 1230 x 2300mm
Ctn size:
1# 2260 x 180 x 170mm, 56/58kg;
2# 1530 x 310 x 180mm, 48/50kg;
3# 840 x 710 x 120mm, 36/38kg;
4# 400 x 200 x 180mm, 16/17kg
G.W./N.W.: 163/156kg



**FPK014B
POWER SQUAT RACK**

Main tube: 75 x 75 x 3mm
Assembly size: 1300 x 1230 x 2300mm
Ctn size:
1# 2260 x 180 x 170mm, 56/58kg;
2# 1530 x 310 x 180mm, 48/50kg;
3# 840 x 710 x 120mm, 36/38kg
G.W./N.W.: 146/140kg

MULTI PURPOSE POWER CAGE

POWER CAGE FPK021

Main tube:
60 x 60 x 2mm together with
50 x 50 x 2mm or
75 x 75 x 3mm together with
60 x 60 x 3mm two levels
Assembly size:
3460 x 2458 x 2325mm
Package: 1 full set /6 Ctns



COMBINATION - PARTS



FPK021-L
LAT MACHINE -LEFT

Main Tube:
50 x 50 x 2mm or
60 x 60 x 3mm two levels
Carton size:
227 x 35 x 19cm
Weight: 49.5kg for 50/60 tube
Package: 1 set/ ctn

A



FPK021-M
POWER CAGE -MIDDLE

Main Tube:
60 x 60 x 2mm or
75 x 75 x 3mm two levels
Assembly size:
1674 x 1911 x 2309mm
Carton size:
1# 222.5 x 16 x 16cm, 31kgs;
2# 122 x 57 x 17cm, 43.5kgs;
3# 136 x 37 x 18cm, 40kgs
Package: 1 set/ 3ctns

B



FPK021-R
LAT CABLE MACHINE -RIGHT

Main Tube:
50 x 50 x 2mm or
60 x 60 x 3mm two levels
Assembly size:
1674 x 1911 x 2309mm
Carton size:
27 x 35 x 19cm
Weight: 34.5kg for 50/60 tube
Package: 1 set/ ctn

C



FPK021-B
LAT PULLEY -BLACK

Main Tube:
60 x 60 x 2mm
together with 50 x 50 x 2mm
or 75 x 75 x 3mm and
60 x 60 x 3mm two levels
Carton size:
220 x 32 x 18cm
Weight: 28.5kg for 50/60 tube
Package: 1 set/ ctn

D

MORE CHOOSE BASED ON YOUR SPACE



POWER RACK WITH STORAGE FPK021+S

Main tube: 75 x 75 x 3mm;
Power rack with storage:
Wall ball; Medicine ball; Dumbbell; Kettlebell; Barbell holder
All functional attachment can be used

BASIC ACCESSORIES

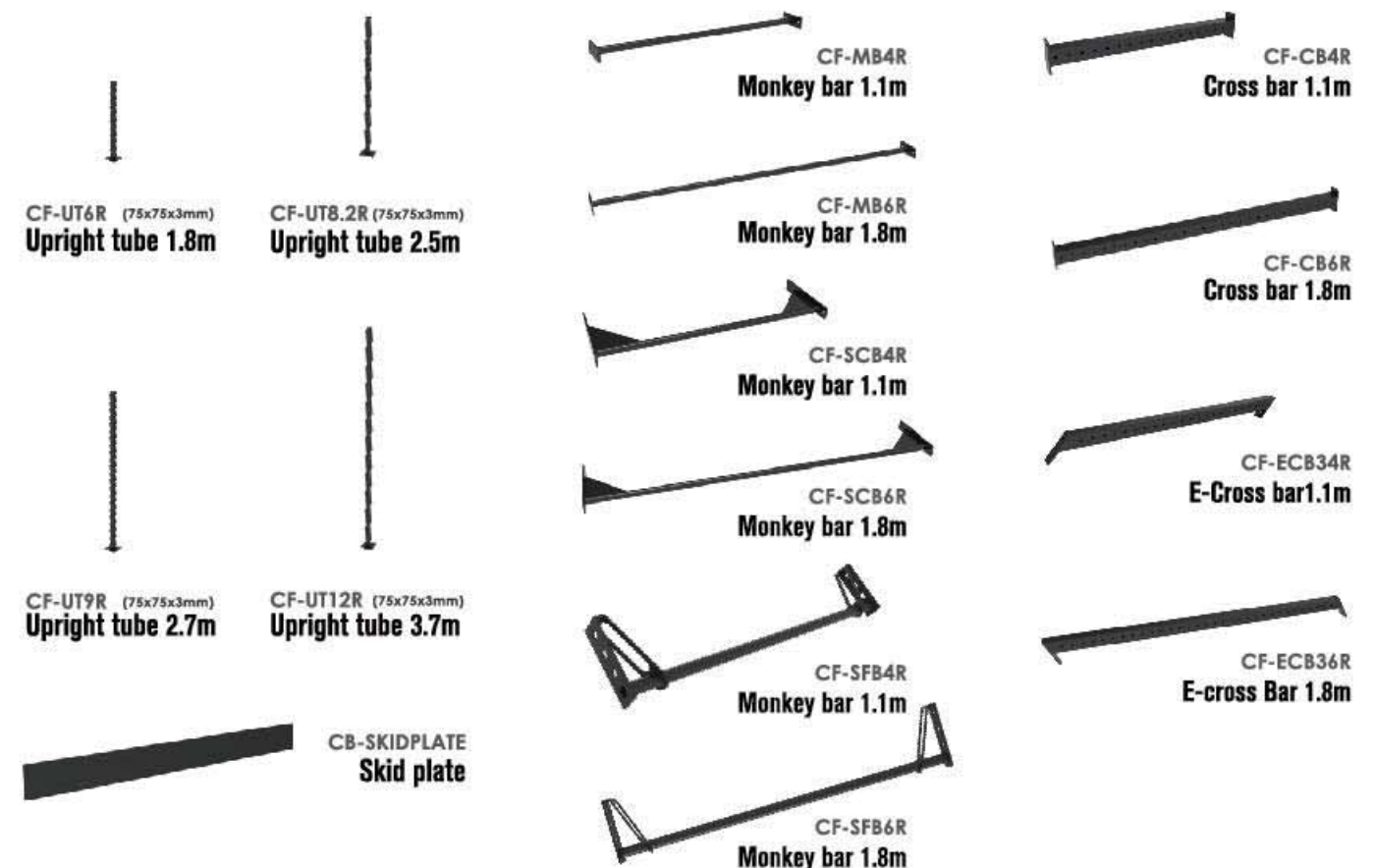

BAR SAFETY HOLDER



CF-BHR
Bar Hook



CF-JCUPS
J hook



CF-SHR-W
Bar safety holder



CF-SHR-P
BAR SAFTY CATCHER



CF-SSH-W
BAR SAFETY



CF-WEBBED CATCHERS
Safety Bar Webbed Catchers

Band pegs



CF-PGST
Power band locker



CF-BP-P
BAND PIN

Target



CB-WBTR
Single Wall Ball Target



CB-2XBWT
Double Wall Ball Target

Timer



TIMER
Gym Timer
- 4"
- Bluetooth
- magnetic spine



TIMER-S
Mini Timer
- 1.5"
- Bluetooth
- magnetic spine



Storage



CF-BP6R
Wall/Slam/Medicine ball storage



CF-HL6R
Kettle bell storage



CF-YLP6R
Dumbbell storage



CF-PH-W
PLATE HOLDER



CF-LP6R
Bumper plates holder



CF-PSR
Olympic dish holder



CF-PBS
Power band storage



CF-BRS
Battle rope storage



CF-SH-W
Bar Safety Holder



CS-DOBH
OB bar Holder



CF-BH-U
OB bar Holder



CF-BH-D
OB bar Holder

Core Training



CF-DBLLM
Double rotational landmine



CF-LM
Single rotational landmine



CF-HBA
Bar attachment core trainer



CF-HPA
Bar attachment Core trainer



CF-BTS
Bar training handle



CF-BTD
Bar training handle

Chin up/ Climb Monkey Bar



CB-CUBAR
Pull up Bar



CF-KPUBR
Pull UP Bar



CF-PU-W
CHIN UP



CF-TB4R
Triangle chin up 1.1m



CF-TB6R
Triangle chin up 1.8m



PUR-MB4R
Pull up Ramp 1.1M



PUR-MB6R
Pull up Ramp 1.8M

Single functional parts



CB-HANGER
Punching bag bracket



JAMMER ARM CF-JA-W



DIPPING CF-SDHR-W



ARM DIPPING CF-DHR-P



PRK003
BUMPER PLATE RACK



WFP-01
WEIGHT LIFTING PLATFORM



WFP-02
WEIGHT LIFTING PLATFORM



CF-LHR-S
Single leg holder Roller



CF-LHR-P
Single leg holder Roller



CF-PLYBOX
MONSTER UTILITY SEAT



CF-HTB1
MONSTER LITE
HIP THRUSTER BENCH



ML-AKA
Monster Lite Arm Kit Attachment



ML-ABS
Belt Squat



CF-SMITH
SMITH STATIV



CF-DHR
Dip Horn



CF-MLIFT
Shoulder weight lift



CF-SUP
Jump step



CF-PJAS
Pro Jammer Arms



IGB001
INVERSION BOOTS



DR-DHR
Dip Bar



CF-RTP
Rowing training pad



CF-BRA
Battle rope anchor



CF-STP
Rig attached step



CF-STEP
Rig attached step



CF-HTB2
MONSTER HIP THRUSTER BENCH

Grip Attachment



A: CB-DSHAP



B: CB-LBULB



C: GRIP-CB-DOGBONE



D: GRIP-CB-LBULB



E: GRIP-CB-PIPEBOMB



SZ-R-0100



LMG-010



HGF-002



AS-M-002



CF-MGT



VCH001



HGT-001



HGT-002



HGT-003



WRT001



ACA001



VCH002

POWER RACK

Extremely stable base to support the hardest cross trainer.
Perform any exercise you would normally perform on a regular power rack such as presses, lifts, squats.
Comes complete with weight storage unit, safety spot arms, bar holders, pull-up bar, band attachments.
Weight storage system



POWER SQUAT RACK

FPK001

Main tube: 75 x 75 x 2mm
Assembly size: 1320 x 1530 x 2140mm
Ctn size:
1# 2105 x 260 x 165mm, 36.5/38kg;
2# 1555 x 525 x 165mm, 53/55kg
G.W./N.W.: 93/89.5kg

POWER SQUAT RACK

Super 3 IN 1 Multi-Machine: Half Rack/smith machine/ back pully system / Squat/ chin up/ rowing/ Lat up and down/ core training/ storage
Two levels choose as below



POWER RACK WITH 6 PCS UPRIGHT TUBES

FPK012-6

Main tube: 75 x 75 x 3mm
Assembly size: 1510 x 1755 x 2510mm
1set including: 10pcs plate holders; 1pr J-hook;
1pc logo plate; 1pr safety belt catcher
Package: 1# 256 x 21 x 16cm, 34/38kg; 2# 113 x 65 x 11cm
3# 80 x 53.5 x 16cm 4# 112 x 32 x 13.5cm
5# 256 x 21 x 16cm, 34/38kg; 6# 256 x 21 x 16cm; 34/38kg



POWER RACK WITH 4 PCS UPRIGHT TUBES

FPK012-4

main tube: 75 x 75 x 3mm
All accessories can be added according to your customazflon



POWER SQUAT RACK WITH LAT PULL SYSTEM

FPKT050

Main tube: 50 x 50 x 2 mm
Assembly size: 153 x 143.5 x 211cm
Ctn size: 1# 196.5 x 12 x 12.5cm, 23/25kg;
2# 112.5 x 37 x 17.5cm, 37/40kg;
3# 203 x 34 x 15cm, 20/23kg



POWER SQUAT RACK WITH LAT PULL SYSTEM

FPKT030

Main tube: 60 x 60 x 3mm
Ctn Size: 1# 1995 x 170 x 155mm, 50/52kg
2# 1095 x 300 x 185mm, 25/26.5kg
3# 1530 x 515 x 205mm, 46/49kg
4# 1335 x 285 x 145mm, 35/37kg
5# 520 x 510 x 270mm, 34.5/36.5kg
6# 290 x 110 x 135mm, 25/25.5kg
7# 290 x 110 x 135mm, 25/25.5kg
8# 290 x 110 x 185mm, 25/25.5kg



POWER SQUAT RACK

FPK016
Main tube: 60 x 60 x 2mm
Assembly size:
1250 x 1210 x 2120mm
Ctn size:
1# 2050 x 310 x 160mm, 55/57kg
2# 1230 x 435 x 170mm, 38/40kg
G.W./N.W.: 97/93kg



POWER SQUAT RACK

FPK002

Main tube: 75 x 75 x 2mm
Assembly size: 1200 x 1300 x 2200mm
Ctn size:
1# 2210 x 335 x 140mm, 38/40kg
2# 1190 x 535 x 155mm, 42/44kg
3# 1190 x 400 x 170mm, 27/29kg
4# 530 x 530 x 80mm, 5.2/3.9kg
5# 370 x 210 x 100mm, 3.6/3.9kg
G.W./N.W.: 120/117kg



DIFFERENT ANGLES



FPK023
POWER RACK WITH STAINLESS STEEL BRAND BOARD

Main tube: 75 x 75 x 3mm
Assembly size: 2230 x 1846 x 1266mm



HALF RACK FPK004-1

Main tube: 50 x 50 x 3mm
Assembly size: 1300 x 1745 x 1800mm
Package: 1set/ctn
Carton size: 175.5 x 32.5 x 17cm
N.W./G.W.: 40/43 kg



HALF RACK FPK004-2

Main tube: 60 x 60 x 3mm
Assembly: 1410 x 1080 x 2230mm
Including 1pr J hook
Package: 1set/2ctns
Carton size: 1# 227 x 15 x 8cm;
2# 136 x 35.5 x 18cm
N.W./G.W.: 52/55 kg



HALF SQUAT RACK FPK004

Main tube: 75 x 75 x 3mm Assembly size: 1415 x 1230 x 2360mm
Ctn size:
1# 2580 x 190 x 100mm, 41/43kg; 2# 1400 x 360 x 170mm, 40/42kg
3# 330 x 260 x 110mm, 5/6kg; 4# 760 x 5190 x 110mm, 16/17.5kg
N.W.: 102kg G.W.: 108kg



HALF RACK FPK006A / FPK006B

B is higher compare with A
Main tube: 60 x 60 x 3mm
Assembly size: A: 1830 x 1200 x 2390mm B: 1830 x 1200 x 2730mm
Height: A: 2390mm B: 2750mm
Ctn size:
1# 2080x 420 x 180mm, 58/61kg; 2# 2370 x 155 x 75mm, 22/24kg
N.W.: 80kg G.W.: 85kg



FOLD SQUAT RACK FPK005/FPK005A

Main tube: 75 x 75 x 3mm
Assembly size: 1200 x 600 x 2300mm
Ctn size: 1# 2340 x 175 x 105mm, 29/31kg
2# 1240 x 230 x 170mm, 32/35kg



WALL MOUNTED SQUAT RACK FPK012

Main tube: 75 x 75 x 3mm Assembly size: 1230 x 820 x 2430mm
Ctn size:
1# 2350 x 190 x 100mm, 31/33kg; 2# 1130 x 260 x 190mm, 37/39kg
N.W.: 68kg G.W.: 72kg



FUNCTIONAL TRAINER WITH SMITH

VCMS002

Main tube: 75 x 75 x 3mm
 Assembly size: 2200 x 985 x 2283mm
 Steel stacks: 70kg x 2 sets
 Packing: 1set/wooden case



ALL IN ONE TRAINER

AT002B

main tube: 80 x 50 x 3mm; 50 x 50 x 3mm
 Assembly size: 149 x 191 x 232cm
 steel stacks: 60kg x 2
 packing: 1set/wooden case



POWER SQUAT RACK FULL COMMERCIAL TYPE

FHR054P

Main tube: 75 x 75 x 3mm, ϕ 25 solid steel
 Assembly size: 1861 x 1745 x 2339mm
 Weight: 210/220kg



LIGHT COMMERCIAL ECONOMIC TYPE POWER SQUAT RACK

FHR054C

Main tube: 75 x 75 x 2mm, ϕ 25 x 2mm steel
 Assembly size: 1861 x 1745 x 2160mm
 Weight: 160/170kg



SMITH HALF RACK

GPS01A

Main tube: 60x60x3mm
 Assembly size: 195x167x221cm
 Package: 1set/W.cs



WALL MOUNT SMITH STATIV

CFR17010

Main tube: 75 x 75 x 3mm;
 Assembly size: 50 deep x 120 width x 240cm Height

MULTI FUNCTIONAL TRAINER

FRT9904

Weight bar holders/Cable cross/Smith/attachment/
 Squat rack/Multi chin up bar
 Main Tube: 70 x 50 x 2 mm and 50 x 50 x 2mm
 Weight: 180 kg
 Assembly size: 190 x 153 x 227 cm
 Packing: 221 x 40 x 18cm, 57 x 50 x 23cm
 219 x 40 x 17cm, 76 x 57 x 16cm
 184 x 21 x 11cm, 14 x 12 x 34cm
 113 x 56 x 22cm



Leg expander can be attached



CROSS MACHINE VCMS001-S/W

Main tube: 100 x 50 x 3mm;
 Assembly size: 229 x 210 x 85 or 213 x 150 x 85cm
 Steel weight: 68kg x 2 (150LB x 2) 19+1 pcs or
 80kg x 2 (180LB x 2) 17+1 pcs
 steel cover height : 75cm or 172cm
 cable 6mm dia; pull up handles; lat down handles;
 Max user: 180kg Package: 1set / 2 wooden case



MULTI POWER SQUAT RACK FPK015

Main Tube: 75 x 75 x 2 mm
 Assembly size: 140 x 111 x 215 cm
 Ctn size: 1#: 895 x 855 x 170mm, 34/37kg;
 2#: 1350 x 545 x 165mm, 28/30kg;
 3#: 1365 x 430 x 185mm, 27/29.5kg



LAT MACHINE LMT0007

Main Tube: 80 x 40 x 2.5mm,
 Adjustable Weight: 50kg Steel Stack
 Assembly Size: 590 x 542 x 2010mm
 Package:1# 2046 x 225 x 195mm, 39/42kg
 2# 770 x 575 x 155mm, 26.7/28kg
 3# 290 x 110 x 135mm, 25/25.5kg
 4# 290 x 110 x 185mm, 25/25.5kg

COMMERCIAL POWER WEIGHT BENCH

FULL COMMERCIAL WIEGHT BENCH BH008

Main tube:75 x 75 x 3mm
 Assembly size: 2121 x 1745 x 1556mm
 Package: 1set/wooden case, 163 x 103 x 59.5cm
 Weight: 236kg

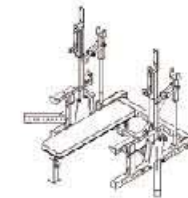

WEIGHT BENCH BH003

Main tube: 75 x 75 x 3mm
 Assembly size: 1670 x 2082 x 1350mm
 Ctn size:
 1# 122.5 x 31 x 8cm, 4/5kg 2# 108 x 73 x 17cm, 35/38kg
 3# 80 x 46 x 20cm, 30/33kg 4# 130 x 53 x 24cm, 38/40kg



WEIGHT BENCH BH004

Main tube: 100 x 100 x 3mm or 75 x 75 x 3mm
 Assembly size: 1483 x 1321 x 940-1300mm
 Ctn: 1set/5 ctms
 Max user: 200kg



VLM053PS LAT MACHINE

Main tube: 70 x 50 x 2mm
 Assembly size:1490 x 803 x 219mm
 Steel weight strack 115kg
 Package:
 1/2 ctn and one wooden case
 1# 39/42kg 216.5 x 33.5 x 14cm
 2# 30/32kg 93 x 54.5 x 24.5cm
 3# 115/130kg 690 x 310 x 260mm



VLM053PF LAT MACHINE

Main tube: 70 x 50 x 2mm
 Assembly size: 1490 x 803 x 219mm
 Package: 1/2 ctn
 1# 39/42kg 216.5 x 33.5 x 14cm
 2# 30/32kg 93 x 54.5 x 24.5cm



LMT053A LAT MACHINE

Main Tube Size: 70 x 50 x 2.0mm
 Assembly size: 145 x 98 x 213cm
 Pakcing: 1pc/2ctn
 Packing Size: 205 x 30 x 10cm;
 85 x 56 x 17cm
 G.W./N.W.: 50/46kg



LMT0008 LAT MACHINE

Main Tube: 70 X 50 X 2.5mm,
 Pad 6.5mm Mixed High Density Foam
 Assembly Size: 1402x1000x2086mm
 Package: 1# 1220 x 435 x 260mm, 46/49kg
 2# 2050 x 290 x 55mm, 17.5/19kg



WEIGHT BENCH BH002

Main tube: 75 x 75 x 3mm Assembly size: 1725 x 1515 x 1450mm
 Ctn size: 1# 1630 x 190 x 170mm, 47/49kg
 2# 1200 x 310 x 120mm, 45/47kg 3# 1280 x 340 x 90mm, 3/4kg
 4# 330 x 260 x 110mm, 5/6kg 5# 760 x 5190 x 110mm, 16/17.5kg
 N.W.: 116kg G.W.: 123kg



WEIGHT BENCH BH005

Main tube: 70 x 50 x 2mm
 Assembly size: 1830 x 1610 x 1120mm
 Ctn size: 1# 1155 x 915 x 180mm, 26.5/28.5kg
 2# 1240 x 430 x 225mm, 26/28kg
 3# 690 x 500 x 60mm, 4.5/5kg



CHEST PRESS MACHINE WITH LEG EXTENSION

BHLF-011

Main tube: 70 x 50 x 2mm
 Assembly size: 2580 x 1410-1700 x 1200mm
 Packing: 1set/2ctns;
 1# 119.5x45x24cm, 38/41kg
 2# 124x64.5x19cm, 37/40kg



CHEST PRESS MACHINE WITH LAT PULL DOWN

BHLF-011A

Adjustable bench add the lat tower
 Main tube: 70 x 50 x 2mm

FID BENCH

With transport wheel and handle for easy moving. All angles can be adjust to fit for different exercise.

6 levels adjustment

FID BENCH

BT001

Main tube: 70 x 50 x 2mm
 Assembly size: 1460 x 660 x 510mm
 Ctn size: 1400 x 480 x 170mm
 N.W.: 28kg G.W.: 30kg

5 levels adjustment

FID BENCH

BT005

Main tube: 70 x 50 x 2mm
 Assembly size: 1385 x 535 x 450 (flat height)
 Ctn size: 1355 x 440 x 255mm
 N.W./G.W.: 43.5/44.5kg

9 levels adjustment

FID BENCH

BT008

Main tube: 75 x 50 x 3.0mm 50 x 50 x 2.0mm
 Assembly size: 1345 x 654 x 453mm (flat height)
 Ctn Size: 127 x 39 x 30cm
 N.W./G.W.: 29/31kg

7 levels adjustable

FID BENCH

BT009

Main tube: 100 x 50 x 2mm
 Assembly size: 1360 x 730 x 485mm
 Ctn size: 1300 x 480 x 280mm G.W/N.W: 34.5/31.5kgs

7 levels adjustment

FID BENCH

BT004

Main tube: 70 x 50 x 2mm
 Assembly size: 1600 x 600 x 510mm
 Ctn size: 1300 x 540 x 170mm
 N.W.: 30kg G.W.: 32kg

12 levels adjustment

FID BENCH

BT002

Main tube: 75 x 75 x 2mm
 Assembly size: 1325 x 765 x 465mm
 Ctn size: 1380 x 610 x 170mm
 N.W.: 36kg G.W.: 1

9 levels adjustment

FID BENCH

BT006

Main tube: 70 x 50 x 2mm
 Assembly size: 1460 x 660 x 470-1210mm
 Ctn size: 1260 x 470 x 200mm
 N.W.: 26kg G.W.: 27.4kg

8 levels adjustable

FID BENCH

BT007

Main tube: 70 x 50 x 2mm
 Assembly size: 1465 x 685 x 45-135mm
 Ctn size: 1410 x 470 x 210mm N.W.: 35kg G.W.: 36kg

7 levels adjustable



FID BENCH - FOLDABLE BT010

FID commercial bench which can upright stock to save your space.
 Main tube: 75 x 75 x 3mm or 75 x 75 x 2mm
 Assemble size: 138 x 63.5 x 45-139cm
 Ctn size: 130 x 59 x 24cm
 N.W.: 44kg G.W.: 46kg



FID BENCH - FOLDABLE BT010A

FID commercial bench which can upright stock to save your space.
 Main tube: 75 x 75 x 3mm or 75 x 75 x 2mm
 Assemble size: 138 x 63.5 x 45-139cm
 Ctn size: 130 x 59 x 24cm
 N.W.: 44kg G.W.: 46kg

5 levels adjustable



MULTI ADJUSTABLE TRAINING AND STORAGE BENCH MUB001

Main tube: 30 x 30 x 2.0mm
 Assembly size: 1404 x 420 x 507mm
 Ctn size: 143.5 x 46.5 x 50cm
 N.W.: 77.5kg G.W.: 80.5kg

5 levels adjustable



MULTI ADJUSTABLE TRAINING AND STORAGE BENCH MUB002

High intensity interval training adjustable bench with attachment storage (dumbbell/kettle bell/slam ball and so on)
 Main tube: 25 x 25 x 1.5mm
 Assembly size: 1350 x 360 x 520mm
 Ctn size: 1410 x 440 x 570mm N.W.: 59kg G.W.: 62kg



FLAT BENCH BP001

Main tube: 75 x 75 x 2mm
 Assembly size: 1200 x 565 x 450mm
 Ctn size: 1380 x 610 x 170mm
 N.W.: 25kg
 G.W.: 26kg

BP001A transport wheel and handle
 Main tube: 75 x 75 x 2mm
 Assembly Size: 1325 x 555 x 440mm
 Carton size: 1225 x 460 x 205mm
 N.W./G.W.: 25/26kg



FLAT BENCH BP002

With transport wheel and handle for easy moving.
 Main tube: 75 x 75 x 2mm
 Assembly size: 1470 x 590 x 430mm
 Ctn size: 1410 x 410 x 220mm
 N.W.: 19kg G.W.: 21kg



FLAT BENCH

FLAT BENCH BP010A

Main tube: 75 x 75 x 3mm
 or 75 x 75 x 2mm
 Assembly size: 147 X 59 X 45cm
 Carton size: 141 x 41 x 22cm



12 levels adjustable



BT011A ADJUSTABLE BENCH WITH LEG EXTENSION

Main tube: 75 x 50 x 3mm and 50 x 100 x 3mm
 Assembly size: 130 x 60 x 46cm
 N.W./G.W.: 47/52kg
 Carton size: 133 x 63 x 30cm

11 levels adjustable



FID BENCH BT012

Main tube: 75 x 75 x 3mm
 Assembly size: 143 x 64 x 45cm
 Package: 1set/ctn
 Carton size: 126 x 35 x 25cm
 N.W./G.W.: 26/27kg





MULTI FLAT-INCLINE-DECLINE BENCH

FIDX2002

Main tube: 80 x 40 x 2mm and Ø60 x 1.5mm
 Assembly size: 1320 x 645 x 1220mm
 Ctn size: 122 x 40 x 15cm
 N.W.: 19kg G.W.: 20kg

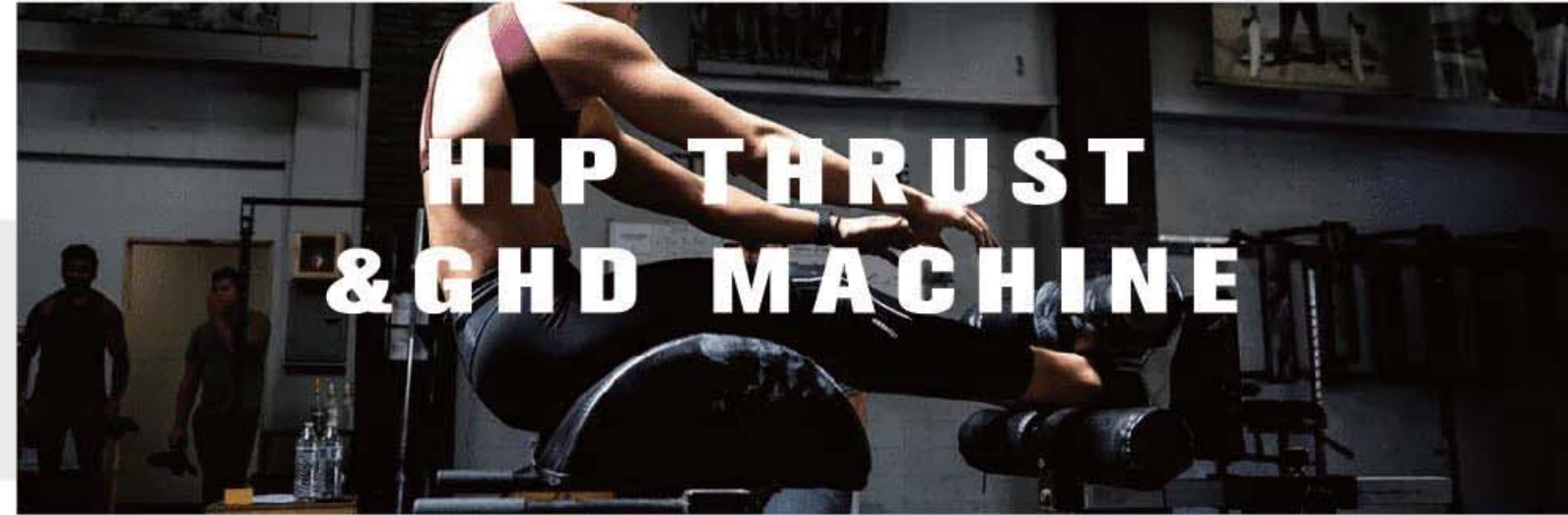

WEIGHT BENCH

BHLF-022

Main tube: 60 x 60 x 2.5mm; pad 6.5mm mixed high density foam
 Assembly size: 1399 x 1210 x 1125-1575mm
 package: 1# 1160 x 510 x 240mm, 30/34kg
 2# 965 x 335 x 325mm, 22/24.5kg



WEIGHT BENCH

WBS3660B

Main tube: Ø76 x 1.5mm, Ø50 x 1.5mm
 Assembly size: 1050 x 1800 x 1800mm
 Ctn size: 1#: 104 x 44.5 x 17cm, 16/17kg,
 2#: 151 x 65.5 x 18cm, 32/34kg



**BG011
 COMMERCIAL TYPE HIP THRUST MACHINE**

Main tube: 70 x 50 x 2mm
 Assembly size: 1660 x 865 x 540mm
 Package: 1set/2ctns
 1# 185 x 34 x 10cm, 25/27kg
 2# 89 x 74 x 25.5cm, 28/30kg



MULTI-TRAINING BENCH

BHLF-030

Main tube size: 100 x 50 x 2.0mm
 Assembly size: 1620 x 760 x 810mm
 Weight: 52kg



MULTI-TRAINING BENCH

BHLF-021

Main tube size: 100 x 50 x 2.0mm
 Assembly size: 1620 x 760 x 810mm
 Weight: 57kg



HIP THRUST MACHINE

BG004

Main tube: 60 x 60x 2mm
 Assembly size: 1575 x 900 x 460mm
 Carton size: 162 x 53 x 12.5cm
 N.W./G.W.: 32.3/35.5kg



GLUTE HAM DEVELOPER

BG008

Main tube: 70 x 50 x 2mm
 Assembly size: 1650 x 900 x 620mm
 Package: 1set/ctn



GLUTE HAM DEVELOPER

BG010

Main tube: 70 x 50 x 2mm
 Assembly size:
 1789 x 1082 x 1045mm
 Carton 1:
 70 x 47 x 31cm, 13.5/15.5kg
 Carton 2:
 114 x 82 x 14cm, 51/54kg



GLUTE HAM DEVELOPER

BG001

Main tube: 50 x 50 x 3mm
 Assembly size: 1720 x 1020 x 1200mm
 Ctn size:
 1# 1760 x 1080 x 200mm, 50/52kg;
 2# 540 x 440 x 280mm, 15/16kg
 G.W./N.W.: 68/65kg



GLUTE HAM DEVELOPER

BG014

Matt black powder coating
 Main tube: 75 x 75 x 3mm
 Assembled size: 1990 x 832 x 1528mm



GLUTE HAM DEVELOPER

BG003

Adjust length and height to fit for
 different size trainers.
 Assembly size:
 1780 x 865 x 1065mm
 Main tube: 70 x 50 x 2mm
 Ctn size: 1610 x 870 x 330mm
 G.W./N.W.: 71/64kg



COMMERCIAL TYPE BACK TRAINER

BTW1157

Main tube: 75 x 75 x 3mm
 Assembly size: 1590 x 715 x 918mm
 Carton size: 99 x 78 x 30cm , 73/75kg



GLUTE HAM DEVELOPER

BG006F

Main tube: 75 x 75 x 3mm
 Assembly size: 1970 x 1120 x 1290mm
 Ctn size: 1# 660 x 490 x 270mm , 9kg
 2# 1080 x 620 x 140mm , 37kg
 3# 1970 x 310 x 180 mm , 53kg



GLUTE HAM DEVELOPER

BG006

Main tube: 70 x 50 x 2mm
 Assembly size: 2050 x 810 x 1180mm
 G.W./N.W.: 57/55kg



SISSY SQUAT BENCH

LBX9006

Main Tube: 100 x 50 x 2mm
 Assembly size: 103 x 48.5 x 63cm
 Carton size: 102 x 49 x 14.5cm , 21/23kg



**FLBS005
 SINGLE LEG CROUCH**

Main tube: 70 x 50 x 3mm



LEG LIFT BENCH

FLBS004

Main tube:
 70 x 50 x 2mm, 50 x 50 x 2mm
 Assembly size:
 675 x 620 x 490mm
 Ctn Size:
 630 x 580 x 130mm; 15/16kg



GLUTE HAM DEVELOPER BG013

Main tube: 75 x 75 x 2mm,
 Assembly size: 1810 x 916 x 1144mm
 Ctn size: 1# 183 x 20 x 16cm
 2# 95 x 45 x 19cm
 3# 74.5 x 54.5 x 28.5cm
 N.W./G.W.: 137/143kg



GLUTE HAM DEVELOPER BG009

Main tube: 70 x 50 x 2mm and 50 x 50 x 2mm
 Assembly size: 1300 x 1070 x 1104mm
 Ctn size: 1# 98 x 66 x 15cm , 6/7kg
 2# 134 x 35 x 18cm , 45/47kg
 3# 106 x 36 x 18cm , 42/44kg
 4# 100 x 95 x 11cm , 34/36kg
 Package: 1set/4 ctns



GLUTE HAM DEVELOPER COMBO BG015

Main tube: 70 x 50 x 3mm
 Assembly size: 188 x 120 x 106cm
 Weight: 128kg



VERTICAL LEG PRESS VLP-001

Main tube: 70 x 50 x 3mm
 Assembly size: 1692 x 1829 x 2005mm



SLEDS MS001

Main tube: Ø57 x 3mm
 Assembly size: 940 x 645 x 970mm
 Ctn size: 1000 x 680 x 130mm
 G.W./N.W.: 38/36kg



SLEDS MS002D

Main tube: 70 x 50 x 2mm,
 Ø57 x 3mm, Ø48 x 2mm
 Assembly size: 1150 x 600 x 1055mm
 Ctn size:
 1# 1150 x 480 x 120mm, 35/37kg
 2# 610 x 290 x 180mm, 10/11kg
 G.W./N.W.: 48/45kg



FOUR FEET SLEDS MS004

Main tube: 50 x 20 x 2mm
 Assembly size: 1150 x 795 x 990mm
 Ctn size: 1180 x 830 x 180mm
 G.W./N.W.: 30/28kg



SLEDS MS005

Main tube: 70 x 50 x 2mm
 Assembly size: 882 x 635 x 909mm
 Ctn Size: 1000 x 540 x 130mm
 G.W./N.W.: 37/38KG



SLED HARNESS BBJ001

Attachment for the sled.



SLED HARNESS BBJ002

Attachment for the sled.



AIR BIKE

ABK001

Assembly size: 1280 x 540 x 1229mm
 Package size: carton+foam
 Weight: 45kg
 20'GP: 88pcs



STAIR TRAINER

ST001

Computer: 13.3" with time, height, step, calorie, plus, level
 Power : 220V
 Stairs: 25 degree angle; 8 sets process and 4 sets
 target process; Max loading: 200kg
 Step area:240 x 560mm; 50pcs per min



CURVE TREADMILL

CTX8002

Assembly size: 2000 x 900 x 1530 mm
 Package size: wooden case , 1950 x 900 x 670 mm
 Equipment size: 1900 x 890 x 1600 mm
 MAX USER weight: 190kg
 Width of running board: 490mm
 20'GP: 24pcs
 Weight: 155kg



SPIN BIKE

YK-8732

Main Frame: Oval 40 x 80 x 1.5mm; Φ76 x 1.5mm; 30 x 70 x 1.5mm
 Adjustable handlebar; 3pcs of Crank Arm; Friction braking system
 5PK Belt; 15kg flywheel; Dia 420 mm
 Assembly size: L1050 x W510 x H1130mm;
 Max user: 120kg
 Weight: 39kg
 Package:
 111 x 86 x 22.5cm



EXERCISE BIKE

ABK002

Assembly size: 1250 x 605 x 1220mm
 Max loading: 150kg
 Package: 1pc/ctn



TZ3000C

CURVE TREADMILL WITHOUT RESISTANCE

Assembly size: 178 x 84.5 x 152cm
 Max loading: 200kg
 Package: 1pc/wooden case



CURVE TREADMILL ADD RESISTANCE

TZ3000A

Assembly size: 227 x 85.5 x 150cm
 Max loading: 200kg
 Package: 1pc/wooden case



SKIING MACHINE

SIM001

Assembly size: 1320 x 610 x 2159mm
 Package size: carton+foam
 Weight: 48kg
 20'GP: 66pcs



AIR ROWING MACHINE

RM005

Assembly size: 2710 x 620 x 995mm
 N.W./G.W.: 30kg / 35kg
 Max loading: 200kg
 Carton size: 1420 x 420 x 570mm
 Display screen: press key
 Package: 1pc/ctn



FLOORING MAT

Perfect for exercise rooms, multi-functional training area and locker rooms
Shock absorbent and sculpt resistant
Easy to install, low maintenance

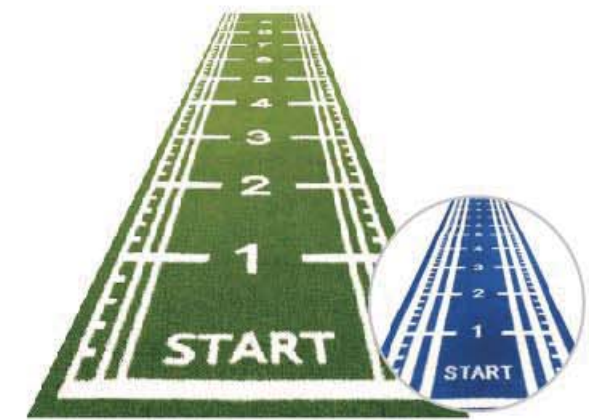

ARTIFICIAL GRASS MAT FM-GRASS-01

Size: 2m x 10m Weight: 2.4~2.5kg/square meter
Density: 15750/cluster Grass height: 25mm
Material: PE



ARTIFICIAL GRASS MAT FM-GRASS-02

Size: 2 x 10m/25m or 4 x 10m/25m
Weight: 2.4kg / square meter Density: 58800/cluster
Grass height: 15mm Material:PE



PVC PROTECTION MAT FM-RM-04

Material: PVC Size: 183 x 90 x 0.6cm
Package: 1pc/shrink wrap, 6pcs/ctn
Carton size: 93 x 38 x 26cm, 16/17kg



RUBBER FLOORING ROLLS FM-RM-01

Size: 1m or 1.25m Width x 10m or 20m Length
Thickness: 4mm/5mm/6mm/7mm/8mm/9mm/10mm
10%EPDM



RUBBER GYM FLOORING FM-RM-02

Size: 50 x 50cm; 60 x 60cm; 100 x 100cm
Thickness: 15mm/20mm/25mm/30mm/40mm

FM-RM-05 EPDM FLOORING MATS

Material: Rubber
Size: 50 x 50cm; 100 x 100cm
Thickness: 15mm/20mm/25mm/30mm



EVA GYM FLOORING FM-RM-03

Size: 60 x 60cm; 100 x 100cm
Thickness: 1.2cm/2.0cm/2.5cm/3.0cm/4.0cm

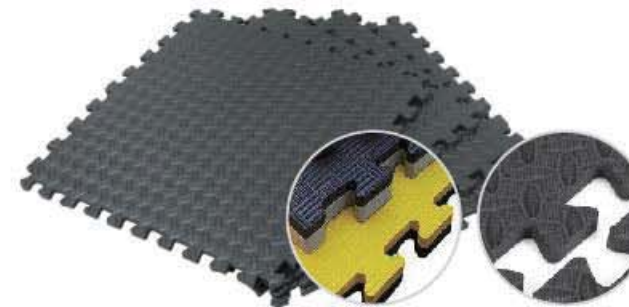

FLOORING MAT EM-001

Material: Rubber
Size: 50 x 50cm / 50 x 19cm / 19 x 19cm
Thickness: 0.6cm and 1.2cm



FOAM ROLL MAT EM-002

Material: EVA
Size: 198 x 90 x 0.8cm / 180 x 90 x 0.8cm



ROLL OUT AGILITY LADDER LD003

The Roll Out Ladder resists bunching-up and stays in place on all types of indoor surfaces, and select outdoor surfaces.
Size: 454 x 41 x 0.35cm

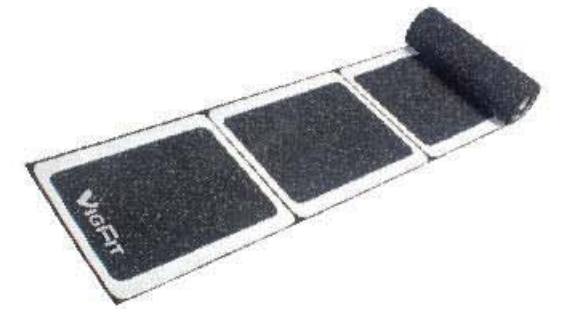



RUBBER HEXAGON BARBELL BBL-001

Weight: 10/15/20/25/30/35/40/45kg



RUBBER DODECAGON HEAD BARBELL BBL-006

Weight: 10/15/20/25/30/35/40/45kg

STEEL CHROMED DUMBBELL

Steel head with colorful inside and stainless steel outside cover, locked by hard screws
Dumbbell handle bar is Zinc Black; head is hard chromed



DB-R-301/DB-P-301
HEX RUBBER / PEV DUMBBELL

Weight: 1kg-10kg each 1kg up;
12.5kg-50kg each 2.5kg up;
55kg-80kg each 5kg up 3lb/
5lb/8lb/10lb/12lb/15lb/20lb/
25lb/30lb/35lb/40lb/45lb/
50lb/55lb/60lb/65lb/70lb/
75lb/80lb/85lb/90lb/95lb/
100lb/105lb/110lb/120lb



DB-R-301R
FULL RUBBER HANDLE



DB-R-301CF
DB-P-301CF
COLORFUL RUBBER HEAD OR PEV HEAD



DB-R-301C
CAMO RUBBER HEAD



DB-R-301MH



CAN ADD PVC LOGO OR PRINT BRAND
DODECAGON HEAD RUBBER DUMBBELL DB-R-312

Material: Rubber + Steel;
Can Add Print Brand Or Print Brand
Weight: 2.5kg-50kg; Each 2.5kg Up



ROUND HEAD PU DUMBBELL DB-R-303

Weight: 2.5kg-50kg; each 2.5kg up



DB-P-002

STAINLESS STEEL / STEEL CHROMED COMMERCIAL DUMBBELL DB-S-001

Weight: 2.5kg-50kg; 2.5kg Each Up, 50kg-80kg: 5kg Each Up, 80KG-100KG; 10KG UP; 100-200KG: 50KG UP
Handle Bar Dia: 25/28/30/33mm



DB-S-002
Steel chromed dumbbell with bamboo cap



DB-S-003
Weight: 2.5kg-200kg



SQUARE HEAD TPU DUMBBELL DB-P-010

Material: Tpu + Steel; Can Add Laser Brand
Weight: 2.5kg-50kg; Each 2.5kg Up



ROUND HEAD CPU DUMBBELL DB-R-311

Material: Cpu + Steel; Can Add Laser Brand
Weight: 2.5kg-50kg; Each 2.5kg Up

PRO
STYLE



BLACK PAINTING STEEL KETTLEBELL WITH COLORFUL RINGS

KB-C-203

Size: 10,15,20,25,30,35,40,45,50,60,70,80,90,100,105lb/8,10,12,14,16,20,24,28,32,36,40,44,48kg



KB-I-106C
CAMO

PRO STYLE KETTLEBELL KB-I-106

Size: 4,6,8,10,12,14,16,20,24,28,32,36,40,44,48kg

KB-P-001
URETHANE COMPLETION KETTLEBELL

The Origin Urethane Kettlebells are built to the highest quality High durable and has added bonus of not marking floors or equipment

Weight: 8-32kg; each up 4kg,10-80LB,each up 5LB



**2 LAYERS
COMMERCIAL KETTLEBELL RACK**

PRK012

Main tube: 70 x 50 x 2mm
Assembly size: 50cmL x 120cmW x 70cmH
Cln 1: 73 x 55 x 22cm; Cln 2: 124 x 28 x 6cm
Packing: 1pc/2ctns
G.W/N.W: 31/29kgs



KB-R-301
RUBBER KETTLEBELL WITH CHROMED HANDLE

Featuring a rugged rubber shell and smooth handle. These kettlebells help both athletes and everyday exercises achieve outstanding results
Weight:
4kg/6kg/8kg/10kg/12kg/
16kg/20kg/24kg



KB-R-301C
COLORFUL RUBBER KETTLEBELL



HAMMER HM001

Weight: 4kg-40kg
Material: Steel

**STEEL KETTLEBELL
WITH STAINLESS HANDLE**

KB-S-202B

Stainless Steel kettlebells have an unpainted handle, allowing chalk to stick better. Competition colors are used for easy identification. All kettlebells are the same size and diameter-makes going up in weight an easier transition.

Weight: 8kg/10kg/12kg/14kg/16kg/18kg/20kg/22kg/24kg/28kg/
32kg/40kg/44kg/48kg



KB-S-202A STEEL PAINTING HANDLE KB-S-202D STEEL CHROMED HANDLE HG-008 SILICONE HANDLE GRIP



WEIGHT LIFTING

Bumper plate with good durability and quality. Follow the standard IWF 450mm in diameter.



COMPETITION TYPE COLORFUL FULL RUBBER BUMPER PLATE

PL-R-505

Drop test: 1.8mx15000 times
Weight:
5kg-black/light grey/white
10kg-Green 15kg-Yellow
20kg-Blue 25kg-Red
10,25,35,45,55LB



BLACK HI-IMPACT BUMPER PLATE

PL-R-506

Drop test:
1.8mx10000 times
Weight:
5kg/10kg/15kg/20kg/25kg
10lb/25lb/35lb/45lb/55lb



PL-R-506C



COLORFUL RUBBER BUMPER PLATE

PL-R-501

Drop test: 1.8mx8000 times
Weight KG/LB:
5kg-black or light grey,
10kg-Green, 15kg-Yellow,
20kg-Blue, 25kg-Red
10LB, 15LB, 25LB, 35LB, 45LB, 55LB



BLACK COMPETITION FULL RUBBER BUMPER PLATE

PL-R-510

Weight: 5kg/10kg/15kg/25kg;
10lb/15lb/25lb/35lb/45lb/55lb
Widdle steel plate dia:190mm

STANDARD OB STEEL PLATE

Size:1.25kg/2.75lbs;2.5kg/5.5lbs;5kg/11lbs;10kg/22lbs;15kg/33lbs;20kg/44lbs;25kg/55lbs



COLORFUL PU BUMPER PLATE

PL-P-006

Bumper plate with TOP quality. Follow the standard IWF 450mm in diameter. Are designed with durable stainless-steel inserts and a distinctive smooth finish that provides an economical weightlifting for large-scale strength training facility. Steel rim bushing.
Drop test: 1.8mx8000 times
Weight: 5kg-black; 10kg-Green; 15kg-Yellow; 20kg-Blue; 25kg-Red



TECHNIQUE PLASTIC BUMPER PLATE

Material: PE
Size: 2.5/5kg and 5/10LB
Diameter: 450mm



PU PLATES WITH HANDLE

PL-P-001

Urethane OB plates. Gym club best choose.
Commercial resistance to high impacts. Stainless Steel Rim Bushing.
Weight: 1.25kg/2.5kg/5kg/10kg/15kg/20kg/25kg





BLACK FULL RUBBER BUMPER PLATE WITH COLORFUL SIDE PL-R-507

Steel rim Bushing
Drop test: 1.8mx 8000 times
Weight: 5kg ,10kg ,15kg , 20kg , 25kg/10LB , 25LB , 35LB , 45LB , 55LB



BLACK FULL RUBBER BUMPER PLATE PL-R-502

Steel rim Bushing
Drop test: 1.8mx 8000 times
Weight: 5kg ,10kg ,15kg , 20kg , 25kg/ 10LB , 15LB , 25LB , 35LB , 45LB , 55LB



PU / RUBBER PLATE WITH HANDLE PL-R-001

Size: 1.25/2.5/5/10/15/20/25kg



RUBBER PLATE WITH HANDLE PL-R-311

Size: 1.25/2.5/5/10/15/20/25kg



TPU WEIGHT PLATES PL-T-002

Material: TPU
Size: 5/10/15/20/25KG



FRACTIONAL PLATE COLORFUL PL-R-504

Every bit counts when you're chasing that PR. Add as little as 0.5kg to your bar to ring that PR bell. Set includes 1 pair of each size. Weight: 0.5kg/1kg/1.5kg/2kg/2.5kg/5kg Colorful type or black type



CAMO BUMPER PLATES PL-R-511

Size: 5/10/15/20/25kg
10/25/35/45/55LB



STEEL WEIGHT PLATES WITH SILICONE RING PL-S-515S

Size: 0.25kg/0.5kg/1.25kg/2.5kg/5kg /10kg/15kg/20kg/25kg



STEEL WEIGHT PLATES PL-S-515

Size: 0.25kg/0.5kg/1.25kg/2.5kg/5kg /10kg/15kg/20kg/25kg



STEEL WEIGHT PLATES WITH HANDLE PL-S-516

Size: 5/10/15/20/25kg



BUMPER PLATE RACK PRK002

Bumper plate cart with transport wheel
Main tube: 75x75x2mm; Dia 48x2mm;
Assembly size:132x48x27cm
Carton Size:135x48x27cmp; N.W/G.W: 15.5/17kg



RUBBER PLATE WITH HANDLE PL-R-306

Size: 1.25/2.5/5/10/15/20/25kg
2.5/5/10/25/35/45LB



GREY HAMMERTONE PLATE PL-I-105

Size: 1.25/2.5/5/10/15/20/25kg
2.5/5/10/25/35/45LB



WALLMOUNT PLATE RACK PRK001

Steel board: 15mm thickness
Assembly size: 171 x 53.5 x 25cm
Carton size: 89 x 37 x 14cm, 11kg

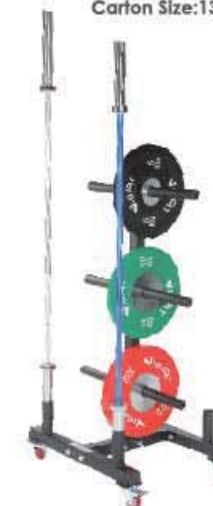

Easy Transport With Wheel
BAR AND PLATE RACK PRK004

Moveable OP plate and OB Bar rack
Main tube: 60x60x3mm; Dia 48x2mm
Assembly size:80x63x148.5cm
Carton Size:143x35x14cm
N.W/G.W: 37/39kg

Surface	Hard Chromed	Black hard Chrome+QPQ	Hard chrome+Black Hard chrome	Cerakote+QPQ	Black Zinc	Camouflage+QPQ	Black Zinc+Titanize
Use	Multi-Purpose	Weight lifting	Power lifting	Dead lifting	Technique/Speciality		
Logo	End Cap	Rubber sleeve	Middle Printing	Sleeve engraving			
Bearing	Copper sleeve	Needle bearing	Graphite Bush				
Knurling	P1.2 Standard	P1.5 Aggressive					

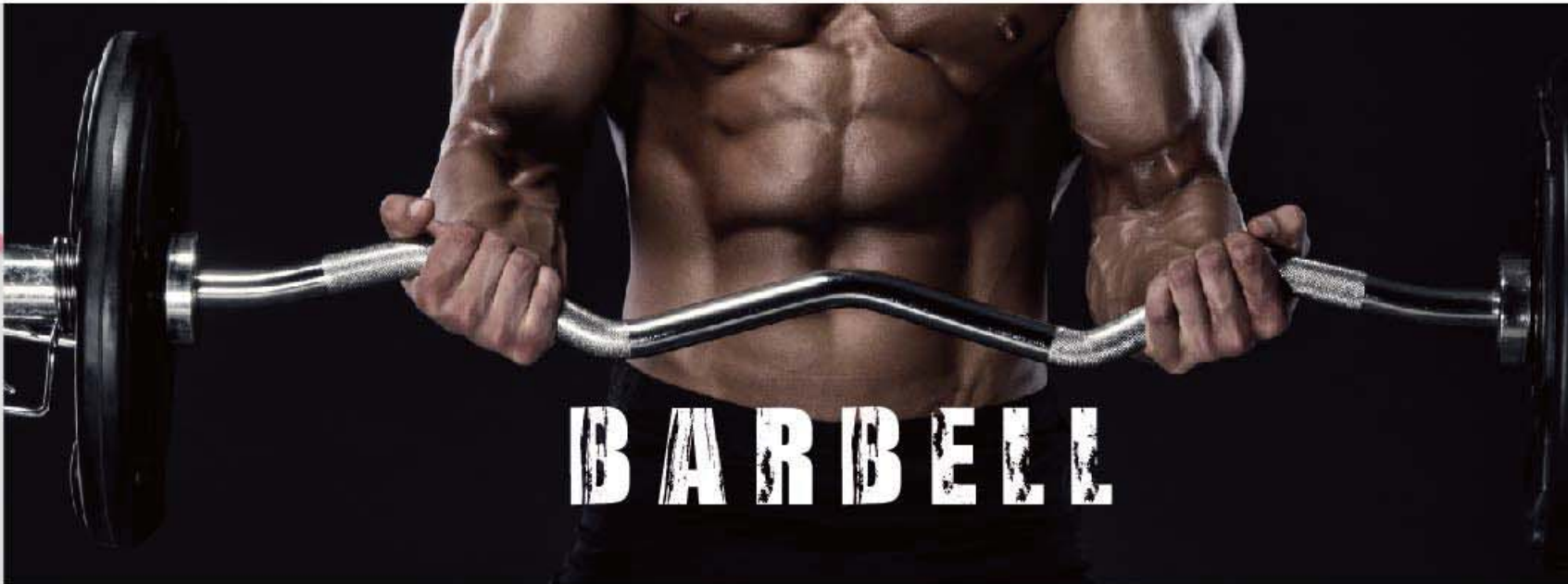

Multi-Purpose :Designed to work well for both Powerlifting,Weightlifting and everything in between

MEN'S BAR

Professional Men's Training Bar 2200mm

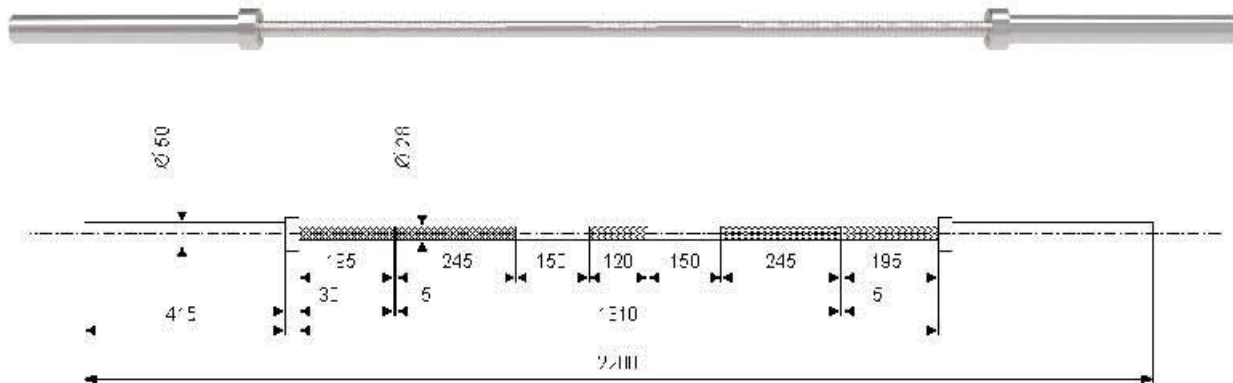

Colorful Ceramics powder coating



Item No.	Max loading	Material	KPSI	Weight	Inner Bar Dia	Brass Bushing	Bearing	OB Sleeve Length	Knurl	Use
VOB86-H	2000LB	60Si2Mn	215K	20kg	28MM	2PCS	Needle x10pcs	415mm	P1.2x6parts	Multi-Purpose
VOB86	1500LB	42CrMo	200K	20kg	28MM	2PCS	Needle x8pcs	415mm	P1.2x6parts	Multi-Purpose
VOB86-L	1000LB	42Cr	190K	20kg	28MM	2PCS	Needle x2-4pcs	413mm	P1.2x4parts	Multi-Purpose
VOB86-I	1500LB	42CrMo	210K	20kg	28MM	2PCS	Needle x10pcs	415mm	P1.2x5parts	Weight Lifting

WOMEN'S BAR

Professional Women's Training Bar 2010mm

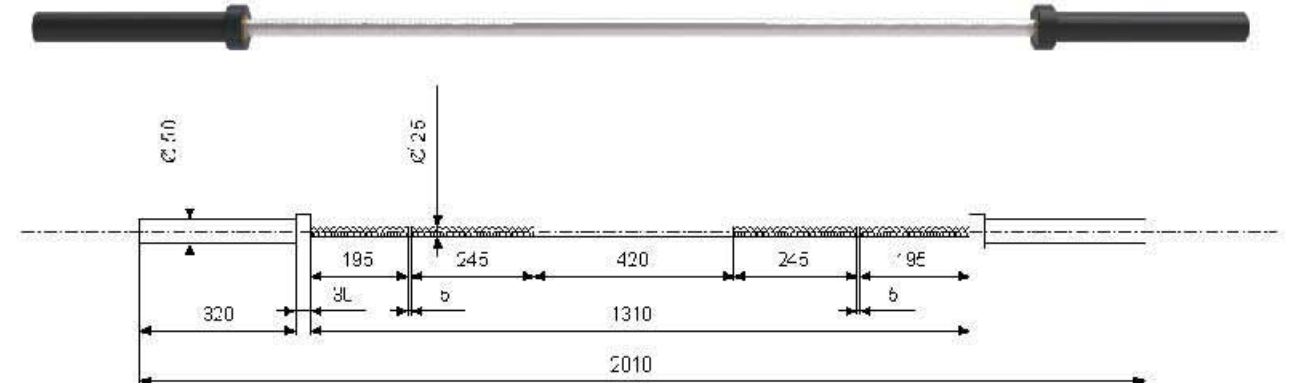

Colorful Ceramics powder coating



Item No.	Max loading	Material	KPSI	Weight	Inner Bar Dia	Brass Bushing	Bearing	OB Sleeve Length	Knurl	Use
VOB80-H	1500LB	60Si2Mn	210K	15kg	25MM	2PCS	Needle x4pcs	330mm	P1.2x6parts	Multi-Purpose
VOB80	1000LB	42CrMo	195K	15kg	25MM	2PCS	Needle x4pcs	330mm	P1.2x4parts	Multi-Purpose
VOB80-L	700LB	42Cr	190K	15kg	25MM	2PCS	Needle x2pcs	330mm	P1.2x4parts	Multi-Purpose
VOB80-I	1000LB	42CrMo	210K	15kg	25MM	2PCS	Needle x4pcs	317mm	P1.2x4parts	Weight Lifting

POWER LIFTING BAR

Professional Power Lifting Bar

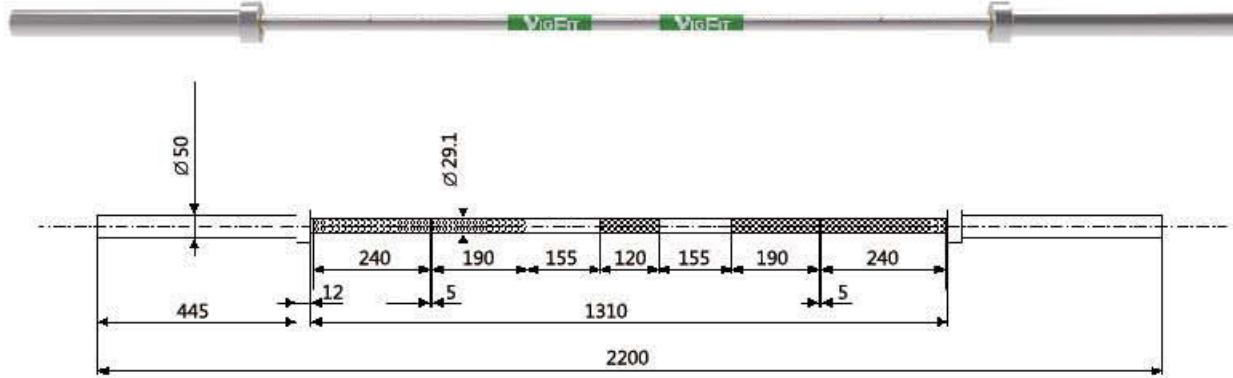

More colors

- Black
- Red
- Grey
- Orange
- Green
- Blue
- Pink
- Camou

Item No.	Max loading	Material	KPSI	Weight	Inner Bar Dia	Brass Bushing	Bearing	OB Sleeve Length	Knurl	Use
VOB86P	1500LB	42CrMo	190±5%	20kg	29MM	2	Graphite sleeve x4	445mm	P1.5X5 Parts	Power Lifting
VOB86P-H	2000LB	42CrMo	205±5%	20kg	29MM	2	Graphite sleeve x4	430mm	P1.5X5 Parts	Power Lifting

DEAD LIFTING BAR

Professional Dead lifting Bar

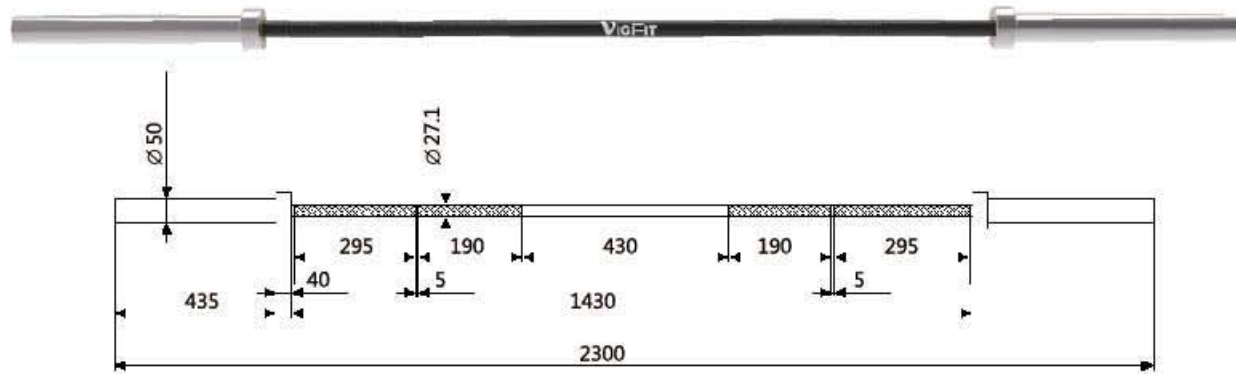

More colors

- Black
- Red
- Grey
- Orange
- Green
- Blue
- Pink
- Camou

Item No.	Max loading	Material	KPSI	Weight	Inner Bar Dia	Brass Bushing	Bearing	OB Sleeve Length	Knurl	Use
VOB86D	1500LB	42CrMo	190±5%	20kg	27MM	2	Graphite sleeve x4	435mm	P1.5X4 Parts	Dead Lifting
VOB86PD-H	1500LB	42CrMo	205±5%	20kg	27MM	2	Graphite sleeve x4	395mm	P1.5X4 Parts	Dead Lifting

TECHNICAL TRAINING BAR

Professional Technical Training Bar



More colors

- Black
- Red
- Grey
- Orange
- Green
- Blue
- Pink
- Camou

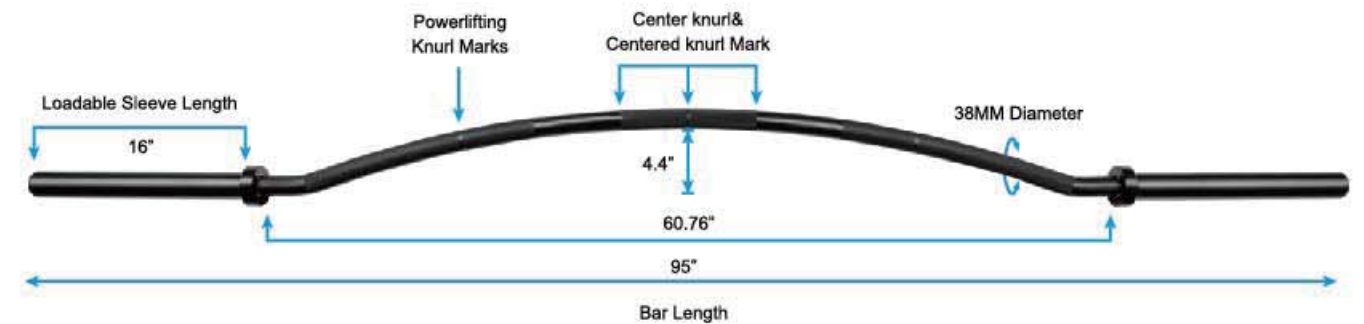

Item No.	Item Name	Max loading	Material	KPSI	Weight	Inner Bar Dia	Brass Bushing	Bearing	OB Sleeve Length	Knurl
OB-AL-48	Mini Bar	120LB	Aluminium	42K	2kg/5LB	22MM	2	Needle bearing x2	95mm	P1.2X6 Parts
OB-AL-72	Technique Bar	150LB	Aluminium	42K	5kg	25MM	2	Needle bearing x2	230mm	P1.2X4 Parts
OB-AL-79	Technique Bar	150LB	Aluminium	42K	10kg	28MM	2	Needle bearing x2	330mm	P1.2X6 Parts
OB-T-70	Training Bar	700LB	Alloy steel	190K	15kg/35LB	28MM	2	Needle bearing x2	305mm	P1.2X6 Parts
OB-C-95	Camber Bar	900LB	Alloy steel	Radian-4.4"	27/60LB±3%	38MM	2	Needle bearing x0	405mm	P1.5X6 Parts

Item No.	Item Name	Surface	Use
OB-AL-48	Mini Bar	Anodized/Aluminium oxides	Technique/Specialty
OB-AL-72	Technique Bar	Anodized/Aluminium oxides	Technique/Specialty
OB-AL-79	Technique Bar	Anodized/Aluminium oxides	Technique/Specialty
OB-T-70	Training Bar	Black Zinc	Technique/Specialty
OB-C-95	Camber Bar	Cerakote+Chromed	Power Lifting/Specialty





QUICK LOCKED POWER LIFTING BAR PLB-001

Bar is full machined made, using advanced composite bushings and 230,000 PSI tensile. bushings bearing: 8 self-fabricated
 Length: 86" Max Loading: 2500 lbs
 Shaft Dia: 29mm
 Weight: 20kg



TB-001 TITANIUM BAR (WEIGHT LIFTING OR FUNCTION TRAINING)

Weight: 20kg, 42crmo material, 8pcs needle bearings with brass bushing, max loading 1500lb, middle bar 28mm



LANDMINE PLATE STYLE 6MM STEEL BOARD LADM-001

Assembly size: 37 x 36 x 39cm
 Both OB and RB



MONSTER LANDMINE LADM-002

OB barbell and RB barbell exchange



BARBELL CURL CLEARING BRUSH BCB-001

Size: 15.5 x 6.4 x 3cm
 Material: Steel line, Nylon, bristles



BARBELL CLEANING KIT BCK-001

One set: 1pcs brush+1 bottle cleaning oil+ 1 pc towel



BARBELL DISPLAY HOLDER BDH001

Details: Main tube 80x40x2mm Fit for 10pcs barbell



CL-AL-003 BAR COLLARS
 Aluminum Collar fit for 2" bar



CL-P-004 BAR COLLAR
 Plastic collar fit for 2" bar with magnet



CL-P-002 BAR COLLAR
 Plastic collar fit for 2" bar



CL-R-004 BAR COLLAR
 Plastic collar fit for 2" bar



CL-P-003 BAR COLLAR
 Plastic collar fit for 2" bar



CL-P-13 BAR COLLAR
 Plastic collar fit for 2" bar



CL-S-001 SPRING COLLAR
 Steel spring collar fit for 2" bar



STEEL SLIDE LOCKER CL-S-2.5
 Steel locker for special lifting bar, 2.5kg each



CL-AL-004 BAR COLLAR
 Aluminum Collar fit for 2" bar with magnet



DEADLIFT EXERCISE



TWO DIFFERENT ROTATING HANDLE OPEN HEX SAFETY SQUAT TRAP BAR MG006

Main tube: 50 x 50 x 2mm
 Carton size: 95 x 60 x 20.5cm
 Handle bar size: 50 x 3mm and 32 x 3mm;
 Max loading: 700LBS
 Weight: 21kg
 Length: 2031mm
 Height: 592mm
 N.W/G.W: 23/25kg



SAFTY HEX TRAP BAR MG001

Material: Q235
 Construction: 3 different rotating handles to suit all kinds of hands;
 Bar Unit weight: 26kg Max loading: 700LBS
 Handle bar size: 25/38/50 Main tube: 50 x 50 x 2mm
 carton size: 96 x 43 x 22mm Surface: Powder coating
 Assembly size: 168 x 70 x 27cm



SAFTY HEX TRAP BAR MG002

Material: Q235
 Main tube: 44 x 44 x 2mm;
 Dia 48 x 5mm; 32 x 3mm Bar Unit weight: 27kg
 Max loading: 700LBS Handle bar size: 32mm
 Surface: Powder coating
 Assembly size: 225.4 x 72.5x27cm



SAFTY HEX TRAP BAR MG005

Material: Q235 Main tube: 30 x 3mm; 50 x 1.5mm
 Bar Unit weight: 25kg Max loading: 700LBS
 Handle bar size: 30mm Surface: Chromed
 Assembly size: 166 x 76 x 6cm
 Length: 1400/1600/1800/2200 can choose



MULTI HANDLE LIFTING BAR MG004

Material: Q235 Main tube: 50 x 25 x 2mm; Dia 48 x 5mm
 Bar Unit weight: 20kg Max loading: 500LBS
 Handle bar size: 28 solid steel
 Surface: Powder coating,
 Carton size: 207 x 28 x 20cm
 Assembly size: 203 x 26 x 16cm

MULTI HANDLE LIFTING BAR MG003

Material: Q235 Main tube: 44 x 44 x 2mm; Dia 48 x 5mm
 Bar Unit weight: 20kg Max loading: 500LBS
 Handle bar size: 28 solid steel
 Surface: Powder coating Carton size: 213 x 28 x 9cm
 Assembly size: 208 x 26 x 7cm



TRAP BAR MG-007

Trap Bar is the ideal piece of functional weight training equipment for shrugs, deadlifts and farmers walk, allowing for a greater range of motion through every lift.
 Length: 2200mm
 Painting Handle parts: 28mm
 Chromed OB steel sleeve
 Weight: 23kg Length: 1200/1400/1800/2200mm

SQUAT BAR MG-008

Specifically designed to maintain correct form and technique during weighted squat workouts.Reduces strain and alleviates pressure on shoulders and wrists.Thick padded shoulder rests for maximum comfort.Includes two quick release olympic collars.Knurled grip centre handles.
 Length: 2.2m
 Middle standard bar is 28/30mm diameter
 Head top is OB sleeve
 Weight: 20/23kg Bearing: 700LBS



FARMER BAR MG009

Main tube: 70 x 50 x 2mm ; 50 x 2mm ; 32 x 4mm
 Steel board: 5mm



FARMER WALKING BAR MG010

Main tube: 48 x 3/4/5mm; handle is 32 x 3mm
 Assemble size: 120/150/180/220 x 19 x 8cm; handle width 12cm
 Package: 1pc/ctn

TRAINING BARS

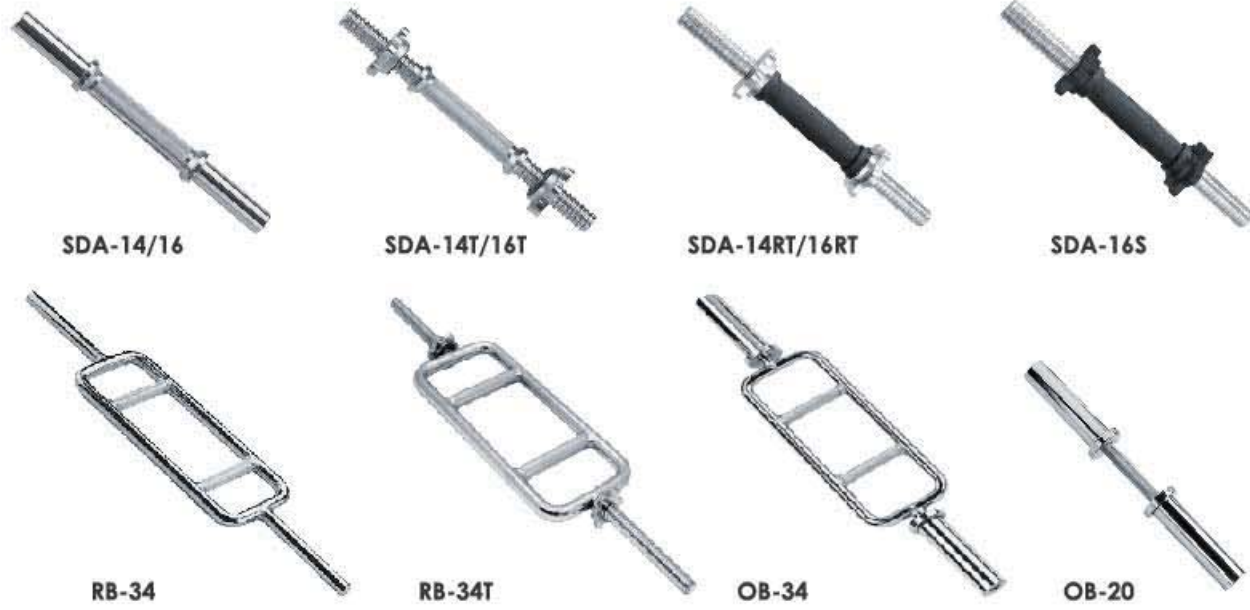

TRAINING ATTACHMENT TRAINING GRIPS





WALL MOUNT
10 PCS OB BAR HOLDER-VERTICAL PRK009

Storage as you need.
Main tube: 5mm steel board
Carton Size: 93 x 16.5 x 13cm
Assembly Size: 89 x 11 x 160cm
N.W./G. W: 14/15kg



6PCS BAR HOLDER FPK009-6

Steel board T5mm
Package: 1set/ctn
Carton size: 60 x 16 x 9cm
N.W./G.W.: 3/4kg



WALL MOUNT
8 PCS OB BAR HOLDER-HORIZONTAL PRK010

Main tube: 5mm steel board
Carton Size: 138 x 13 x 7cm
Assembly Size: 88 x 12 x 135cm
N.W./G. W: 13/14kg



WALL MOUNTED CHIN UP RACK PU004

5 Main tube: 60 x 60 x 2mm; Ø32 x 2mm
Assembly size: 1160 x 590 x 500mm
Ctn Size: 1# 110 x 34 x 14cm, 6/7kg; 2# 63 x 59 x 8cm, 8/9kg
N.W./G. W: 14/16kg



WALL MOUNTED
DIP BAR FOLD TYPE PU005

Main tube: 6mm thickness
board; Ø32 x 2mm
Assembly size:
640 x 640 x 360mm
Ctn Size: 69 x 63 x 11cm
N.W./G. W: 11/12kg



RK6102CE
MULTI WEIGHT LIFTING RACK

Main tube : 50 x 50 x 1.5 mm
Assembly size: 172 x 16 x 16 cm
Ctn size: 1# 172 x 16 x 16 cm, 28/30kg
2# 145 x 34 x 20 cm, 35/37kg



SQUAT RACK FPK009

Main tube: 60 x 60 x 3mm
Assembly size:
700 x 1400 x (1117-1675)mm
Ctn size: 995 x 450 x 200mm
N.W.: 45kg G.W.: 47kg



9 PCS OB BAR HOLDER PRK006

Laser cut brand
Main tube: Diameter 57 x 3mm thickness
Assembly Size: 55 x 55 x 20cm
Carton Size: 59 x 59 x 22cm
N.W./G. W: 26/27.5kg



9 PCS OB BAR HOLDER PRK006F

Main tube: Diameter 60 x 1.5mm
Steel board: 3mm, 4mm
Size: 45 x 45cm
Package: 1pc/ctn
Carton size: 31 x 51 x 21cm
N.W./G.W.: 19/20kg



10 PCS OB BAR HOLDER PRK008

Main tube: Diameter 57 x 3mm
thickness; 70 x 50 x 2mm
Assembly Size: 86 x 63 x 23cm
Carton Size: 91 x 68 x 26cm
N.W./G. W: 17/18kg



SQUAT RAMP SR001

Material: rubber
Size: 70 x 16.5 x 5cm



SQUAT RAMPS SR002

3 in 1 mini squat ramps
Easy carry easy training
Material: rubber
Size: 7.5"x4.7"x3.3"



POWER CHAIN PC-001

Chains can be used to build strength and increase speed and acceleration
 Different levels: 60lb/44lb/30lb/28lb/18lb/12lb
 Can both be separated or as the full set

DEADLIFT BAR JACK DBJ-01

Main tube: 50 x 50 x 2mm
 Assembly size: 1100 x 490 x 910mm
 Ctn size: 1130 x 470 x 170mm
 N.W./G.W.: 9/10kg



BARBELL WEDGE BW001

Material: TPE
 Size: 23 x 4.5 x 3cm

DEAD LIFTING HOLDER DA-002

Main tube: 50 x 50 x 2mm
 Assembly size: 45 x 32 x (30-40)cm
 Carton size: 49 x 69 x 20cm N.W./G.W.: 12/13kg
 Max loading: 800kg
 N.W./G.W.: 12/13kg



PLATE/BAR RACK PBRX7045A/B/C

Main tube size: 60 x 60 x 2 mm
 Assembly size: 740 x 634 x 1275mm



DUMBBELL RACK DMRX502A/B/C

Main tube size: 50 x 50 x 1.5 mm
 Assembly size: 622 x 550 x 980mm



BAR HOLDER BRX8604

Main tube size: 70 x 50 x 1.5mm
 Assembly size: 795 x 60 x 294mm



BARBELL RACK BBRX18602

Main tube size: 100 x 50 x 2.0 mm
 Assembly size: 824 x 770 x 1230 mm



BARBELL RACK BBRX18601

Main tube size: 80 x 40 x 2.0mm
 Assembly size: 780 x 857 x 1225mm



BARBELL RACK BBRX18603

Main tube: 80 x 40 x 2mm
 Assembly size: 902 x 622 x 1464mm
 Carton size: 150 x 65 x 17cm
 Weight: 35kg; Package: 1 set/Ctn

MULTI STORAGE RACK

Order separated functional spare parts to DIY your own storage rack follow your space. Fit for dumbbell, kettlebell; wall ball; medicine ball; bumper plates; barbells; battle ropes, full sets accessories.



SRK001 MULTI STORAGE RACK

Main tube: 60 x 60 x 2mm
 Assembly size: 2700 x 620 x 1510mm
 Ctn size:
 1#: 1550 x 670 x 230mm, 42/44kg
 2#: 1060 x 360 x 380mm, 13/14kg
 3#: 1060 x 360 x 170mm, 28/30kg
 4#: 1060 x 360 x 120mm, 13/14kg
 N.W.: 95kg G.W.: 99kg



SRK002 MULTI STORAGE RACK

4 layers for display wall ball, kettlebell, dumbbell, bumper set
 Main tube: 75 x 75 x 2mm
 Assembly size: 2170 x 770 x 1420mm
 Ctn size:
 1#: 1530 x 310 x 270mm, 43/45kg
 2#: 1550 x 310 x 280mm, 38/39kg
 N.W.: 81kg G.W.: 84kg



SRK003 MULTI TYPE STORAGE RACK

Support upright steel: 6/8mm for choose
 Different layers for choose: Kettlebell;
 Hex dumbbell; Round head dumbbell;
 Wallball
 Different length for choose: 1m/2m
 Can enlarge based on your space



DUMBBELL RACK FOR DUMBBELLS SRK005

Main tube: 75 x 75 x 3mm
 Each layer 6 pcs dumbbells 2 layers
 Can enlarge with upright main body based your space
 Package size: 81 x 64 x 11cm
 81 x 64 x 11cm; 135 x 26 x 9.5cm;
 135 x 26 x 9.5cm



STEEL BLOCK HOLDER

JB-S-001

Main tube: 50 x 50 x 2mm
 Assembly size: 94 x 64 x 90cm
 N.W./G.W.: 35/38 each block

WOODEN TYPE BLOCK HOLDER

JB-S-002

Size: 36"x 20"
 Height: 15"/12"/6"/2.25"
 EO board thickness is 2cm



BARBELL LANDING PAD

LP001

Material: pvc coated, anti-slip surface
 Inside: high mixed bounded sponge
 Size: 76 x 60 x 15cm, 100 x 60 cm x 15/20cm



HIGH DENSITY BLOCK HOLDER

JB-S-003

1set including 2pcs 75 x 50 x 30cm pad; 75 x 50 x 15cm pad;
 4pcs triangle pad 11 x 11 x 50cm
 Material: 1000D Hard coated PVC,
 Inside bonded foam
 Ctn: 1set/ 3export cartons

WEIGHTLIFTING PLATFORM

WLF-R-001A/B/C

Main tube: 38 x 38 x 2mm Size: 244 x 184 x 4cm
 Material: A-Rubber mat and steel frame
 B-Wooden+Rubber mat and steel frame
 C-Bamboo+Rubber mat and steel frame

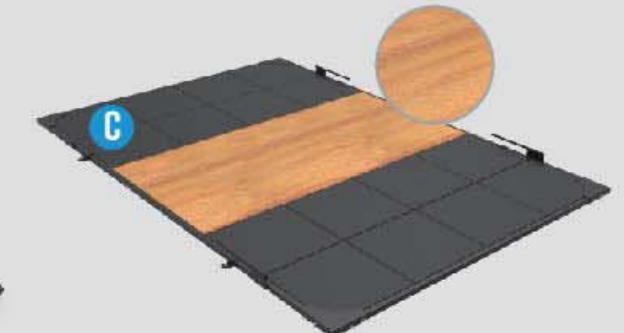
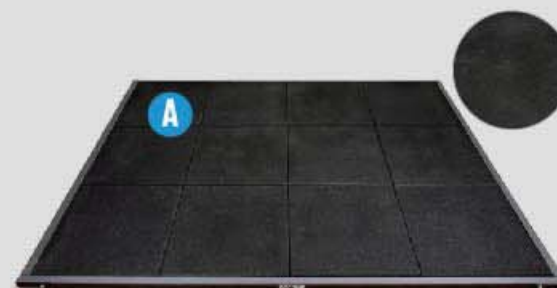



GYM CHALK RACK

CKR001

Main tube: 80 x 40 x 1.5mm; 38 x 38 x 1.5mm
 Assembly size: 42 x 52 x 115cm
 Carton Size: 56 x 47 x 30cm; 82 x 15 x 13cm, 7/9kg



GYM CHALK RACK

CKR002

Main tube: 50 x 50 x 2mm
 Assembly Size: 62.5 x 62.5 x 102cm
 Carton Size: 33 x 33 x 18cm, 3.2/4.5kg;
 81.5 x 22 x 14cm, 9/11kg



SPORT CHALK

CH-001

Material: Magnesium carbonate
 Weight: 8pcs=1lb
 Package: 1 block/white paper;
 8pcs/color box; 36 boxes/ carton



LIQUID GYM CHALK

CH-002

Designed for climbers and can also be used for yoga.Reduces sweating from your hands and feet to add grip. Non toxic.
 Size: 50ml / 100ml / 200ml / 250ml



GYM MAGNESIUM CHALK

Size: 56g,70g,85g,112g



BARBELL PAD

BAP-001

Material: Nylon cover inside NBR foam
 Size: 28 x 80mm
 Length: 400mm or 450mm



BAR PAD

CBAP-002

Material: PU + NBR foam
 Size: 25/28/30 x 350/400/450 mm



WRIST WRAPS

CWW-002

Size: 8W x 62Lcm
 Material: polyester fibre



BAR PAD

BAP-004

Material: EVA foam
 Size: 9 x 45cm



BAR PAD

BAP-005

Material: PU, NBR
 Size: 40 x 9cm



LIFTING STRAPS

LS-001

Material: Strong nylon
 Size: 59.5 x 4cm; Thickness: 2mm
 Weight: 51g



WRIST WRAPS

WW-001

Material: Heavy duty nylon
 Size: 8 x 48cm



HEAD HARNESS

HH-001

Material: Hard nylon with chain



GUT BLASTER AB SLINGS

AS-001

Adjustable strap and oversized D-ring connector to fit with any size bars in your gyms.Heavy duty nylon supports to hold your weight and withstand wear and tear.



THIGH/KNEE WRAPS

WW-002

Size: 8 x 180cm
 Material: Nylon and Latex
 Package: 1pr/color box; 60prs/ctn



TRAINING GLOVES GG009

Material: cowhide , Weight: 0.06kg
Wrist width: 8cm , Height: 15.5cm
Palm width: 11cm , Four-finger width: 9.5cm



TRAINING GLOVES GL-031

Material: silica gel, nylon, neoprene
Color: Black
Size: M/L/XL
Weight: 0.09kg
Assembly Size: 16 x 25 x 3cm



TRAINING GLOVES GL-022

Material: Neoprene + Lycra+
Microfiber + Silicone
Size: S/M/L



**WLB001
LEATHER WEIGHT
LIFTING BELT**

Size: 105 x 11cm;
115 x 11cm;
125 x 11cm



**WLB002
WEIGHT LIFTING BELT
WITH CHAIN**

Material: Leather and steel chain
Size: Chain length is 78cm;
Belt length is 80cm



GYMNASTIC GRIPS GG001

Protect your hands during high rep pull-ups.
Material: High Quality leather with both side textured for added grip
Size: S/M/L/XL



GYMNASTIC GRIPS GG002

Protect your hands during high rep pull-ups.
Material: High Quality leather with both side textured for added grip
Size: S/M/L/XL



GYMNASTIC GRIPS GG004

Material: Carbon & Suede
Size: S(up to 3.15")
M(up to 3.15"- 3.93")
L(up to 3.95"- 4.53")
XL(over 4.53")



WEIGHTLIFTING BELT WLB004

Material: Cowhide or PU leather
Color: Pink Green
Size: S(100 x 10cm)
M(110 x 10cm)
L(120 x 10cm)
XL(130 x 10cm)



WEIGHTLIFTING BELT WLB005

Material: Full Cowhide or PU leather or cowhide and PU leather mix
Size: S(90x10cm), M(100x10cm)
L(110x10cm), XL(120x10cm)
Thickness: 10mm



ANKLE STRAP AS-L-001

Material: Cowhide , Neoprene , hasp
Size: 59 x 6cm



GYMNASTIC GRIPS GG006

Material: cowhide , nylon
Weight: 0.3kg
Packing: opp bag



GYMNASTIC GRIPS GG007

Material: Cowhide , Neoprene
Size: 21 x 8cm



GYMNASTIC GRIPS GG008

Material: Cowhide , Neoprene
Size: 21 x 11cm



**Material: Aluminium
ARB001-AL
Weight: 0.5 kg**

ARM BLASTER

ARB001

Uniquely contoured rigid metal design allows you to isolate your arms and shoulders. Webbed nylon belt, a thick, oversized neoprene neck pad, and dense elbow pads. The strap features a quick release to adjust it to the perfect position. Bulk up your biceps each time you grab a workout bar with the VIGFIT Bicep Bomber.
Dimensions: 23" L x 4" W x 4" H
Material: Steel
Weight: 1 Kg



KINESIOLOGY TAPE KT-001

Material: 100% stretch cotton with high quality medical acrylic glue
Size: 2.5 x 500cm, 40g/ 3.8 x 500cm, 40g/ 5 x 500cm, 80g/ 7.5 x 500cm, 120g/ 10 x 500cm, 160g



MUSCLE BAND RL-L-004

Material: Natural latex
Size: 2" x 7' x 1.3mm
(blue/yellow/red/black)



WRIST STRAPS MLS001

Material: Neoprene, SBR, Steel
Size: 38 x 15 x 7cm
(blue/yellow/red/black)
Weight: 250g

**PD-001
WEIGHT LIFTING BELT WITH CHAIN**

Chain: 3mm/5mm/8mm
Material: High nylon with EVA pad + Steel chain
Size: 85/105/115 x 15 x 10cm



**PD-002
POWER TRAINING BELT**

Material: EVA Width: 15cm
Length: 80/105/115cm



**PD-005
WEIGHTLIFTING BELT**

Material: EVA
Size: S(17 x 85cm), M(17 x 95cm)
L(17 x 105cm), XL(17 x 115cm)





PROFESSIONAL GYM BALL

GB-002

Size: 55cm/2000g , 65cm/2000g , 75cm/2200g
Max loading: 1000kg



MEDICINE BALL

MB002A/B/C/D/E/F/G

Material: rubber
Weight: 1kg/2kg - ø19cm; 3kg/4kg/5kg - ø23cm;
6kg/7kg/8kg/9kg/10kg - ø28.6cm;
2lb/4lb - ø19cm; 6lb/8lb - ø23cm;
10lb/12lb/14lb/16lb/18lb/20lb - ø28.6cm

MEDICINE BALL

MB003

Material: rubber
Weight: 1kg/2kg - ø19cm;
3kg/4kg/5kg - ø23cm;
6kg/7kg/8kg/9kg/10kg - ø28.6cm;
2lb/4lb - ø19cm; 6lb/8lb - ø23cm;
10lb/12lb/14lb/16lb/18lb/20lb - ø28.6cm



MEDICINE BALL

MB001A/MB001B/MB001C

Material: rubber
Weight: 3kg/4kg-ø23cm;
5kg/6kg/7kg/8kg/9kg/
10kg-ø27.2cm/6lb/8lb-ø23cm;
10lb/12lb/14lb/15lb/16lb/18lb/20lb/22lb-ø27.2cm



MEDICINE BALL RACK

RK-M-005

Fit for 10pcs of medicine ball
Main tube: Ø50 x 2.0mm
Assembly size: 65.5 x 81.5 x 146cm



REACTION BALL

RE001

The random bounces of the reaction ball improve overall coordination, reaction time and depth perception. Ball can be bounced off any hard surface.
Diameter: 68mm/155mm; 135g/320g Material: Silicone



REACTION BALL

RE001B

Material: Rubber , TPR
Size: 65mm
Weight: 115g/pc



REACTION BALL

RE001C

Material: Rubber , TPR
Size: 68mm
Weight: 150g/pc

WALL BALL

The soft-shell construction and balanced, uniform weight of this ball make it easy to handle. It is covered with heavy-duty vinyl, coated nylon. Water and scuff resistant. This non-slam, oversized ball is ideal for toss-and-catch activities and soft on the hands. Double stitching/ No sand filling/ Made of heavy-duty vinyl, strong and hard-wearing.



WALL BALL WITH SILICONE PRINT

WB007

Material: Kevlar material and 1000D coated PVC mixed; print brand; with anti-slip silicone printing;
Weight: 3kg/4kg/5kg/6kg/7kg/8kg/9kg/10kg/11kg/12kg/13kg;
5LB/6LB/8LB/10LB/12LB/14LB/15LB/20LB/25LB/30LB/35LB
Diameter: 35.5cm



WALL BALL KEVLAR

WB006

Material: Kevlar material and stitching brand;
Weight: 3kg/4kg/5kg/6kg/7kg/8kg/9kg/10kg/
11kg/12kg/13kg; 5LB/6LB/8LB/10LB/12LB/14LB/
15LB/20LB/25LB/30LB/35LB
Diameter: 35.5cm



WALL BALL

WB001

Made of 1000D PVC coated
Diameter: 35.5cm
Weight: 3kg-13kg; 5LB/6LB/8LB/10LB/12LB/14LB/16LB/20LB/25LB/30LB
Color are optional: ■ ■ ■ ■ ■ ■



WALL BALL

WB002

Anti-slip Wall ball with special pattern
Made of heavy-duty vinyl, strong and hard-wearing
Diameter: 35.5cm
Weight: 3kg-13kg;
5LB/6LB/8LB/10LB/12LB/14LB/16LB/20LB/25LB/30LB



WALL BALL

WB003

Material: PVC
Color: Camouflage Dia: 35.5cm
Weight: 3kg-13kg; 5LB/6LB/8LB/10LB/
12LB/14LB/16LB/20LB/25LB/30LB



WATER POWER BALL

WB010

Material: PVC
Diameter: 30cm/40cm/50cm
Weight: 15kg/30kg/65kg

SLAM BALL

SLB001/002A/002B/002C/002D/002E/002F/002G

Material: Hard PVC, inside sand

Weight:

1kg/2kg/3kg/4kg/5kg/6kg/7kg/8kg/9kg/10kg/12kg/15kg/20kg/25kg/30kg/35kg/40kg/45kg/50kg/55kg/60kg/70kg/75kg/80kg,
4lb/6lb/8lb/10lb/12lb/15lb/20lb/25lb/30lb/35lb/40lb/45lb/50lb/55lb/60lb/65lb/70lb/75lb/80lb/100lb/120lb/150lb

Diameter:

1kg-10kg/4lb-20lb: 23cm/9"; 12kg-30kg/25lb-65lb: 28cm/11"; 35kg-50kg/70lb-100lb: 33cm/13"; 55kg-70kg/120lb-150lb: 36cm/14";
75kg-80kg: 38cm/15"

SLB001



SLB002 line



The storage manager for your studio, wall ball, slam ball, Bar, Rope, Band, Collar, Etc

MULTI STORAGE RACK

PRK013

Material: 65 Steel Board
Assembly Size: 770 x 550 x 305mm
Ctn Size: 810 x 590 x 330mm
G.W./N.W.: 23/21kg

WALL BALL RACK

RK-W-001

Three-layers wall ball rack
with transport wheels
Main tube size:
50 x 50 x 2mm
Assembly size:
150 x 35 x 115cm





POWER BAG



POWER BAG PB003

Material: 1000D high quality coated PVC cover and high oxford as Camouflage type / Fixed filling
 Size: 55 x 22cm Weight: 5kg/10kg/15kg/20kg/25kg
 Color: One level with one color for the head



POWER BAG PB002

Material: 1000D High quality coated PVC cover High quality stitching / Fixed filling
 Size: 22 x 55cm/ 25 x 62cm Weight: 5kg/10kg/15kg/20kg/25kg
 Color: One level with one color for the strap



POWER BAG PB004A

Material: 1000D Cordura power bag with two additional bag in side
 Size: S - 19 x 50cm; Max loading: 40LB
 M - 23 x 62cm; Max loading: 80LB
 L - 28 x 70cm; Max loading: 100LB



PB004B



POWER BAG PB004C

Material: 1000D Cordura power bag with two additional bag in side
 Size: S-Dia 22 x 56cm, 25kg
 M-Dia 25 x 70cm, 40kg
 L-Dia 30 x 88cm, 60kg



POWER BAG PB005

Material: 0.5mm Thickness Hard coating PVC power bag with two additional bag in side
 Size: S-19 x 50cm; Max loading: 40LB
 M-23 x 62cm; Max loading: 80LB
 L-28 x 70cm; Max loading: 100LB



POWER SAND BAG PB006

Filler capacity (6 sizes):
 100lb, 150lb, 200lb, 250lb, 300lb, 400lb zipper and hook-and-loop closure black with white oem logo on flap
 Height: 100LB - 7.5" / 150LB - 11.5" / 200LB - 15.5"
 250LB - 19.5" / 300LB - 22.5" / 400LB - 36" Dia: 16"



WORM POWER BAG PB010

Dia: 26cm, small inner bag max load 30kg, big inner bag max load 100kg
 length 1.5m (2 or 3 empty inner bag-200kg)
 length 2.3m (3 or 5 empty inner bag-360kg)
 length 3.2m (5 or 7 empty inner bag-500kg)



POWER BAG PB001

Versatile training device for improving strength and endurance.
 Various exercises: tearing, swinging, lifting
 Material: Hard coated PVC
 Size: 5/10/15/20/25kg



WATER POWER BAG PB011

Material: PVC
 Size: 12 x 60cm, 6.5kg ; 16 x 75cm, 15kg ;
 20 x 75cm, 20kg ; 25 x 75cm, 35kg
 Weight: 6.5kg/15kg/20kg/35kg



TUMBLER PUNCHING BAG SB-004

Material: 1000D heavy coated PVC
 Foundation size: Φ48 x 45(H)cm
 Body size: Φ30 x 115cm



POWER BAG RACK RK-P-003A

One side power bag rack;
 Fit for 5pcs different weights of bags
 Main side tube: 80 x 40 x 2mm
 and 25 x 2mm



**PBX-S-001
SOFT PLYOMETRIC BOX**

5 levels for the height:
01- L 36" x W 30" x H 3"
02- L 36" x W 30" x H 6"
03- L 36" x W 30" x H 12"
04- L 36" x W 30" x H 18"
05- L 36" x W 30" x H 24"
Material: Anti-slip High quality coated PVC
Inside 3 levels quality: High EVA, Bouncer sponge; EPE



**PBX-W-003
3 IN 1 WOODEN
PLYOMETRIC BOX**

Flat shipping to save the cost
Thickness of board is 1.8cm;
Size: 75 x 60 x 50cm,
60 x 50 x 40cm



**PBX-S-004A / PBX-S-004B
SOFT PLYOMETRIC BOX**

Size: 75 x 60 x 45cm/ 60 x 50 x 40cm
A: outside cover is heavy duty vinyl leather, inter layer is soft material, inside is high density board.
Flat shipping to save the cost.
B: no need assembled, open Carton then uses it.



**PBX-W-008
3 IN 1 WOODEN
PLYOMETRIC BOX**

Thickness of board is 1.8cm;
Size: 75 x 60 x 50cm,
60 x 50 x 40cm



**WOODEN PLYO TRAPEZOID BOX
PBX-W-009**

Trapezoidal wooden plyo box
Size: 6", 12", 18", 24", 30"
Thickness: 1.8mm



**PBX-ST-005
STEEL PLYO BOX**

These plyometric boxes for forward jumps, lateral jumps and other plyometric drills nonslip platform
Maximizes safety 4 levels



**MULTI-FUNCTIONAL
TRAPEZOIDAL BOX**

PBX-S-006

Material: 28kg/m³ EPE filling; 500D hard coated PVC, with anti-slip silicone printing;
Size: 1# 60 x 45cm base; 60 x 25cm top; 30cm height,
2# 100 x 45cm base; 100 x 25cm top; 30cm height
Weight: 1# 2.5kg; 2# 4kg



**MULTI HANDSTAND GYM MAT
PBX-ST-007**

Material: 500D Hard coated PVC, bottom with anti-slip surface, 32kg/m³ EPE filling
Size: Length 336cm; Width: 90cm; Height: 41.5cm; Weight: 33kg
package: 1set / PE bag / export carton

WEIGHT VEST



16kg



10kg



12kg



20kg



30kg

ADJUSTABLE WEIGHT VEST

WV-C-007

One Suit Fit All Guys - Adjustable Belt All Weights Can Be Removed; Weight Cast Iron Block
Material: 1000D Cordura or 1000D hard oxford
Weight Block: 0.95kg/2lb; 1.13kg/2.5lb
Weight: 10kg/12kg/16kg/20kg/26kg/30kg
Package: 1set/carton
More colors:



ADJUSTABLE WEIGHT VEST PRO

WV-C-007P

One Suit Fit All Guys - Adjustable Belt All Weights Can Be Removed; Weight Cast Iron Block
Weight Block: 0.95kg/2lb; 1.13kg/2.5lb Weight: 10kg/12kg/16kg/20kg/26kg/30kg
Material: 1000D Cordura or 1000D hard oxford Package: 1set/carton
More colors:



Patend NO.: ZL202230166189.7

**WEIGHTED WAIST BELT-ADJUSTABLE
WWB003**

Adjustable: waist weight belt
Material: cordura
Weight block: 0.95kg/2lb; 1.13kg/2.5lb
Weight: 10kg/ 12kg/ 20lb/ 25lb





RESISTANCE BAND CORE TRAINING

Single Color RL-L-001



Double Colors RL-L-002



Mixed Color RL-L-003



POWER BAND RL-L-001/RL-L-002/RL-L-003

Material: Latex
8 different levels:

2080 x 6.4 x 4.5mm - Yellow	Resistance: 5-15lb
2080 x 13 x 4.5mm - Red	Resistance: 15-25lb
2080 x 21 x 4.5mm - Black	Resistance: 25-50lb
2080 x 32 x 4.5mm - Purple	Resistance: 50-75lb
2080 x 45 x 4.5mm - Green	Resistance: 100-120lb
2080 x 64 x 4.5mm - Blue	Resistance: 120-175lb
2080 x 83 x 4.5mm - Orange	Resistance: 175-230lb
2080 x 102 x 4.5mm - Grey	Resistance: 230-250lb

Customized Size:
Perimeter: 460/500/550/600/720/900/2080/2250mm
Width: 6.4/13/17/19/21/29/32/45/64/83/102mm
Thickness: 2.5/4.0/4.5/5.0mm



STEEL GYM RING GMR-S-004

Built from stainless steel with a textured black powder coated finish. All the durability of metal with an excellent hand feel.
Diameter of handle: 28mm or 32mm
Width of strap: 2.5cm or 3.8cm
Length of strap: 4.5m or 5.5m



ABS GYMNASSTIC RING GMR-A-001

Dia of handle: Ø1.1";
Width of strap: 1";
Strap length: 15'



WOODEN GYM RING WITH PU SWEATBAND GMR-W-003

Material: birch wood + nylon + PU sweatband
Dia of handle: 32cm or 2.8cm
Width of strap: 2.5cm/3.8cm
Length of strap: 4.5m/5.5m



GMR-W-002



EB-L-007

HIP TRAINING LOOP EB-L-007

Material: Polyester fiber + latex
Light: 66 x 8cm Max 120lb
Middle: 76 x 8cm Max 250lb
Heavy: 86 x 8cm Max 350lb

EB-L-007S



5 IN 1 RESISTANCE LOOP SET EB-L-003C

Material: Latex
Size: 600 x 50 x 0.4mm - Green
600 x 50 x 0.6mm - Blue
600 x 50 x 0.8mm - Yellow
600 x 50 x 1.0mm - Red
600 x 50 x 1.2mm - Black



RL-L-003

SLING SHOT PUSH UP BANDS EB-L-012

Material: Polyester fabric + latex thread
Size: 53 x 11.5cm



360° RESISTANCE SET STS004

Material: Latex/TPR/Nylon
1 Set Including:
1pc Resistance band 240cm
1pc adjust waist belt
Max Loading: 300kg



360° RESISTANCE SET STS005

Material: Latex/TPR/Nylon
1 Set Including:
3 pcs Resistance band 120cm
1pc adjust waist belt
1 pr foam handle



BOUNCE TRAINING SET ST002

Material: Latex tube with nylon cover
1 set including: 1pc waist belt
2pcs resistance tube 2pcs wrist/ankle wrap



CORE SLIDERS CS-001/A/B/C

Weight: 180g/pr
Size: Dia.18cm

AB MAT



AB MAT AB001A

Size: 15" L x 12" W x 2.5"H
Easy Portability / No Set-Up



AB MAT WRAP AB001B

Size: 15" L x 12" W x 2.5"H



AB MAT AM-004

Material: PP+TPE
Size: 31 x 30 x 10cm
Package: 1pc/opp bag/inner box , 10pcs/carton



PILATE SPINAL ORTHOSIS WEDGE SC001

Material: EPP
Size: 97 x 37 x 26 cm

EQUALIZER BAR



PUSH UP STAND COMMERCIAL PU003

Main tube: 38 x 38 x 2mm; ø 32 x 2mm
Assembly size: 60 x 35 x 32 cm



ADJUSTABLE GYM EQUALIZER EQ-003

Main tube: 50 x 50 x 1.5mm
Dia 45 x 1.5mm, dia 38 x 1.2mm
Assembly size: 65 x 52 x (72.5-102)cm
C/n size: 71 x 69.5 x 15cm
N.W/g. W: 10/12kg

EQ-003A
Main tube size:
Dia 38 x 1.2mm, 45 x 1.2mm
Height adjustable: 72-100cm



WOOD PUSH UP BARS PU018

Main tube: 20 x 40 x 1.5mm
Assembly Size: 260 x 160 x 125mm
Material: steel + wooden



WOOD PUSH UP BARS PU019

Main tube: 20 x 40 x 1.5mm
Assembly Size: 490 x 250 x 100mm
Material: steel + wooden



WOOD PUSH UP BARS PU020

Main tube: 20 x 40 x 1.5mm
Assembly Size: 490 x 350 x 300mm
Material: steel + wooden

BATTLE ROPE

Great for building upper body strength. Superior quality "Grade A" manila rope completes with specially-designed mounting bracket for easy installation to ceiling attachments.



BATTLE ROPE WITH RUBBER HANDLE BR001

Material: Polyester fiber Bestselling lengths are 9m/10m/12m/15m
Rubber handle length is 25cm; brand printed on handle



BATTLE ROPE WITH NYLON COVER BR002

Both 38mm/50mm diameter
Material: Polyester fiber + nylon cover
Bestselling lengths are 9m/10m/12m/15m
Rubber handle length is 25cm



HEAVY JUMP ROPE BR001S

Material: Polyester fiber
Lengths: 2.8/3 m
Dia: 25/38 mm



CLIMBING ROPE WITH HOOK CR001

Natural color. Customer lengths are available.
Material: jute
Bestselling lengths are 6m/9m/10m/12m
Rubber handle length is 25cm; brand printed on handle



BATTLE CHAIN BC001

Same function as battle rope, but it's the top training for power guys. Building strength and to increase speed
Customer lengths are available.
Size: Ø20mmx5m/40kg; Ø25mmx5m/65kg; Ø30mmx5m/85kg



HEAVY JUMP ROPE JR-P-015

Material: PP + NBR + PVC
Length: 275cm x 12/15/17.5/22mm
Weight: 470g/700g/1000g/1500g



FITNESS GLOVES GL-009

Fitness gloves for battle rope and battle chain
Anti-slip palm protects your hand



ROPE ANCHOR RA001

No need to wrap your rope around weight room equipment with the rope anchor. Mount it and get to work.



ROPE STORAGE RS-001

Keep your rope out of the way and protected with the rope hanger. The heavy-duty design will hold up to a 15m rope.